

www.westsussex.gov.uk/admissions



Information for Parents Starting School in September 2018

How to apply for a school place.
Important action required.



Apply online at:

□ www.westsussex.gov.uk/admissions

Deadline: Monday 15 January 2018

WS1106.17

Information for Parents Starting School – September 2018

How to apply for a school place – Important action required

Foreword by the Director of Education and Skills

Applying for a place at school is an exciting and important time for children and their parents.

The time has now come for you to take that important step and apply for your child's school place for September 2018. To make the process as easy as possible, West Sussex County Council encourages you to apply using the online application system at www.westsussex.gov.uk/admissions.

All the information you need to help you through the process of applying for a school place is in this booklet. Before completing your application, please take the time to read this important information. The frequently asked questions pages and the admission arrangements for schools may help you decide on the best schools for your child.

Before making your final decision about which schools to apply for, we would strongly encourage you to visit schools and attend their open sessions. This will enable you to find out more about what they can offer your child and give you the opportunity to see the school and meet staff.

Although most children can be given a place at the first preference school, this is not always possible if there are more applications for a school than there are places available. When this happens places will be offered by applying the oversubscription criteria. You are strongly advised to provide preferences for the three different schools you would like your child to attend as this provides you with the best chance of getting your child into a school you want. Remember if you want your child to attend their catchment school, you must include this as one of your preferences.

It is really important that you apply by the national deadline of **Monday 15 January 2018**. Applying after this deadline may significantly affect the school that can be offered.

I wish your son or daughter the very best for when they start at their new school.



Deborah Myers
Director of Education and Skills

CONTENTS

Foreword by the Director of Education and Skills	2
Contents page	3
When you can apply	4
Process timeline	4
Applying for a school place	5
Points to consider before submitting your three preferences	5
Information about addresses	6
Moving house	7
Shared parental responsibility – duplicate and disputed applications	8
SEND Information, Advice and Support Service	8
Looked after children and previously looked after children	8
Private fostering arrangements	9
Applying under the exceptional and compelling category	9
The application deadline, out of time and late applications	10
How places are allocated	10
Frequently asked questions	11
• What is the role of the Pupil Admissions Team?	11
• How likely is it that my preference will be met?	11
• Where can I find out information about schools?	11
• Are West Sussex Infant and Junior Schools linked?	12
• Can I ask for my child to go to any maintained school in West Sussex?	12
• Can I defer my child's start at school?	12
• Can I apply for admission outside my child's normal age group?	13
• Can I delay starting school for my summer born child?	13
• Do special rules apply to twins and multiple births?	14
• What if my child has special educational needs?	14
• How do I apply to a church aided school or academy with a religious character?	15
• If I live outside West Sussex, how do I apply for a West Sussex School?	15
• Can I ask to go to a school outside West Sussex?	15
• Can I make alternative arrangements for my child's education?	15
• My child will be attending an independent school – do I still need to complete the application form?	16
• Can I change my preference?	16
• When will I know if I have a place?	16
• What happens after allocation?	16
• What can I do if I am not offered a place at the school I wanted?	16
• Can I appeal?	17
• Will my child's name be added to the waiting list?	17
• What happens if my child can be offered a place from the waiting list?	18
• Can I appeal or put my child on a waiting list for a school that wasn't one of my original preferences?	18
Contact list for all primary schools and academies in the Northern Area of West Sussex	19
Linked Infant/Junior Schools in the Northern Area	32
Contact list for all primary schools and academies in the Southern Area of West Sussex	32
Linked Infant/Junior Schools in the Southern Area	46
West Sussex County Council's oversubscription criteria	47
Variations to West Sussex County Council's oversubscription criteria in the Northern Area	47
• Maidenbower, Crawley	47
• Southwater, Horsham	48
Variations to West Sussex County Council's oversubscription criteria in the Southern Area	49
• Rose Green Infant School, Bognor Regis	49
• Shoreham Beach Primary School	50
Church aided and foundation schools and academies	51
Transport to school	51
In-year applications to join an established year group (including guidance for Service Personnel and Crown Servants)	54
Glossary – Explanation of words/phrases used in this booklet	56
Useful Contact Telephone Numbers	58
West Sussex Admissions North and South areas	59
Data Protection Act 1998	59

When you can apply

Online applications open on Monday 2 October 2017 and the deadline for making an application is **Monday 15 January 2018**. If your application is received after the application deadline it will not be processed until after all on time applications. This means that your preferences will be considered after all the preferences received on time and increases the possibility that there may not be a place available at the schools you requested or at a local school. After the application deadline you cannot change your preferences unless there is a genuine unforeseeable reason for doing so, for example, if a sibling changes school. Before the application deadline you can amend the preferences by logging back into your online application. **You must re-submit your application every time you make a change to your preferences.** Only your last dated preferences, prior to the deadline, will be considered in the allocation. If you need help making an application, or have any further questions concerning the process after reading this guidance, please telephone 03330 142 903.

West Sussex County Council advertises the starting school application arrangements widely, including through preschool setting and on social media. However, the responsibility for obtaining information and making an application before the deadline rests solely with parents.

Process Timeline:

- **2 October 2017:** The online system opens.
- **15 January 2018:** Application deadline for on time applications and the online application system closes. Please note that the online system is not monitored after the deadline of Monday 15 January and, therefore, any changes to your details after the deadline must be notified to the Pupil Admissions Team by email or post. If you have to complete a paper form it is your responsibility to ensure that the form is returned to your local school by the deadline. Paper forms will not be acknowledged. The most secure way is to apply online. Please note that the governors of church voluntary aided schools and some academies ask parents to complete the school's supplementary Information Form (SIF) by the same closing date. This extra information enables these schools to rank applications correctly against their admissions criteria.
- **January 2018 – March 2018:** Preferences processed and information exchanged with schools and other Local Authorities.
- **15 February 2018:** Processing deadline for receipt of out of time applications made after the application deadline and receipt of evidence regarding a request to change preferences due to a genuine unforeseeable reason. Also the deadline for receipt of evidence for house movers; please see page 7 for further information on the implications of moving during the allocation of places. Any applications received on or after 16 February 2018 will be late applications, received outside of the normal admissions round, and will not be processed until after 15 May 2018.
- **16 April 2018:** On time online applicants will be notified which school their child has been offered by email during the day. No decisions will be issued by telephone. Other applicants will be sent a letter by second class post, posted during the day.
- **16 April 2018 onwards:** Parents accept place at allocated school, register and provide a copy of their current council tax bill as proof of their application address.
- **15 May 2018 onwards:** Late applications received on or after 16 February 2018, made outside the normal admissions round, processed and offer made. Waiting lists will be established and places offered if they become available.
- **May - July 2018 onwards:** Appeals heard by an independent appeal panel.
- **September 2018:** New intake admitted to school.

Applying for a school place

All parents should apply for a school online at www.westsussex.gov.uk/admissions. When you submit your application you will receive an email containing the information on your application as confirmation that your application has been received. Please be aware that all the contact information which you provide will be shared with the allocated school to facilitate starting school arrangements.

Parents who apply online will benefit as follows:

1. You can save your application before submitting it and can therefore return to it to make amendments. You must however still submit the completed application before the deadline of **Monday 15 January 2018**. Before the deadline you can amend your preferences by logging back into your online application. If you make any changes after you have submitted your application you must re-submit your application and you must do so every time you make any further changes. Only your last dated preferences, prior to the deadline, will be considered in the allocation.
2. An acknowledgement of your application is automatically sent by the system so you know your application has been received. You may need to amend your security settings in order to receive the automatic acknowledgement or it may be placed in the "junk" or "bulk" folder. We strongly recommend that you keep a copy of the automated acknowledgement e-mail, which will give you a unique application reference number, as it is your proof that you applied and we cannot investigate issues without this.
3. Free internet access will be available at all West Sussex libraries and Children & Family Centres for parents who do not have access to a computer.
4. Only on time online applicants receive an e-mail on 16 April 2018 confirming the result of their application.

We would advise parents that applying online very close to the deadline (Monday 15 January 2018) could be difficult due to high user volume. Please apply ahead of the deadline, after visiting schools and considering the admission arrangements. The online system will close at 23:59 on Monday 15 January 2018. Please note that the online system is not monitored after the deadline of Monday 15 January 2018 and, therefore, any changes to your details after the deadline must be notified to the Pupil Admissions Team by email or post.

If you have no option but to apply on a paper form, please telephone 03330 142 903 to request one. Please note that it is your responsibility to ensure that a completed form is returned to your local West Sussex school by the end of the school day **on Monday 15 January 2018**. Parents are not encouraged to return their paper forms directly to the Pupil Admissions Team unless they use Recorded Delivery post. Claims regarding missing forms will not be investigated unless you can provide evidence that it was received at the Pupil Admissions Team. West Sussex County Council is not responsible for forms lost or delayed in the post. We recommend that you keep a copy of the form and evidence of posting.

As mentioned previously, please note that the governors of church voluntary aided schools and some academies ask parents to complete the school's Supplementary Information Form (SIF) by the same closing date. This extra information enables these schools to rank applications correctly against their admissions criteria. The school must still consider your application if you choose not to complete the SIF, however failing to do so may affect the priority the Governors give your application.

Points to consider before submitting your three preferences

- Make sure you use all three of your preferences wisely, be realistic and apply on time. School places are allocated according to the published oversubscription criteria for each school so study these carefully. This can include criteria such as whether you live in the catchment area, whether there are siblings already at the school and the distance you live from the school. You have a higher priority for your catchment school. If you make a preference for an oversubscribed school, the further away you live the less likely you are to be offered a place. Personal circumstances, such as child care

arrangements, are not part of the oversubscription criteria for any school and will not be taken into consideration. You are strongly encouraged to include your catchment school as one of your three preferences. If you wish your child to be considered for a place at their catchment school you must include this as one of your three preferences. You can check the catchment school for your address on our website at www.westsussex.gov.uk/admissions. If you do not have access to the internet and you are not sure which is your catchment school please call 03330 142 903 to find out. Please do not include a school you do not want as a preference as you may be offered this school. Please do not put independent schools or Elective Home Education as preferences as they will be disregarded.

- After the deadline you cannot change your preferences unless there is a genuine unforeseeable reason for doing so, for example if a sibling has changed school. You are advised to contact the Pupil Admissions Team to discuss your reason for changing preferences before submitting a new application.
- If you are planning to move house you must notify the Pupil Admissions Team. You may wish to contact the Pupil Admissions Team to discuss your preferences if your house move is not yet confirmed. Further information on moving house is available on page 7. If you change residency before 4 September 2018 without informing the Pupil Admissions Team, this may result in the offer made being withdrawn.
- Church voluntary aided schools and some academies will ask you to complete their supplementary information form to enable the Governors to consider your application against the school's oversubscription criteria. The form may ask for information about church attendance, baptism, parents working at the school etc. The school must still consider your application if you choose not to complete the supplementary form, however failing to do so may affect the priority the Governors give your application. (Supplementary Information Forms are available from the schools, their websites or at www.westsussex.gov.uk/admissions.)
- If you have previously visited a school and completed papers for them, you must still complete an online application before the deadline to apply for a place at the school.
- Church aided schools, foundation schools and academies may have a different policy to West Sussex County Council. Please check the admission arrangements for these schools before making your application.
- Attendance at a pre-school or nursery associated with, or located in, an infant/primary school will not secure a place at the school. Your child is not automatically admitted to a school if offered a place at the nursery.
- The Council does not take account of how long your child has been 'registered' with a school. Registering is purely an expression of interest and has no influence on the admission process.

Information about addresses

The majority of West Sussex Schools have a catchment area. It is important that the address information for each pupil is accurate to ensure the correct priority is applied to the application.

It is the parent's responsibility to notify the Pupil Admissions Team of any changes to their address in writing at any time before 4 September 2018.

All changes of address that are received after the allocation will be reviewed and, if the application gained an unfair advantage and the place would not have been offered, we will withdraw the offer made.

Fraudulent use of addresses

If you are aware that a fraudulent address has been used for an application, you should inform the Pupil Admissions Team in writing providing as much information regarding the child and address as possible. All information will be treated as confidential and will be investigated.

If it is found that a place has been allocated using incorrect or knowingly misleading information which allowed the application an unfair advantage, the offered place will be withdrawn. If the school that should have been offered was full at allocation an alternative will be offered and this may be further away.

Shared residency

The Pupil Admissions Team can only use one address for the purpose of allocating a school place. The address for the application is the one held on our records as being the address for your child. If your child regularly stays overnight with another parent or relative on a shared residency basis and therefore potentially has more than one address, you must confirm this in writing after making your application online. You should give both addresses and details of your child's living arrangements and state which address you believe should be used for the application i.e. your child's main address. We may contact you for further supporting evidence and this could include documentation such as a: council tax bill, medical card, utility bill, bank statement or child benefit documentation. Additional enquiries may also be made where necessary. Priority for your preferences will be decided according to the address which the Pupil Admissions Team determines as your child's main address. Parents should note that overnight stays relating to childcare arrangements are rarely considered to be a formal 'shared residency' and priority will not be given from a relative/carer's address in these circumstances. Parents should submit details of their child's shared residency by covering letter addressed to the Pupil Admissions Team.

Moving house

Moving after an application has been made but prior to allocation

You must make an application through your current Local Authority prior to the deadline of 15 January 2018. If you are planning to move house prior to the new school year in September, you **must** advise the Pupil Admissions Team in **writing** to ensure that your application receives the correct priority for the allocation.

Acceptable confirmation of your new address (a signed tenancy agreement or confirmation of contract exchange for a purchase) must be received by the West Sussex Pupil Admissions Team by 15 February 2018, which is our final processing deadline to allow us to use your new address for allocation. Any changes received after this date will not be processed until 15 May 2015. In these circumstances your previous address will be used for allocation on 16 April 2018 but your new address will be used for correspondence and waiting lists after allocation.

Any school place offered for your child will be on the basis of the address held on the Pupil Admissions Team records and the assumption that **your child will still be resident at this address in September 2018**. If you fail to tell us of a confirmed move before 15 February then your place will be withdrawn.

Moving within West Sussex after school places have been allocated

The Pupil Admissions Team must be advised of any changes to a pupils address in writing at any time before 4 September 2018.

If you are moving within West Sussex and wish to submit new preferences, a new application must be submitted along with acceptable confirmation of the new address. Where availability allows, we will offer the preferred school and the place previously offered will be withdrawn. Where we have to refuse a place because the preferred school is oversubscribed pupils will be placed on a waiting list following an application. We will confirm this and, if necessary, the alternative school offered when we write to you refusing you a place at the preferred school.

Moving into West Sussex after school places have been allocated

Pupils moving into West Sussex from outside the county after the allocation date with an acceptable confirmation of address can make applications direct to West Sussex County Council. If acceptable confirmation of the new address is not available, an application should be made via your current Local Authority, requesting your preferred schools in West Sussex. Where availability allows, we will offer your preferred school and the place previously offered by your Local Authority will be withdrawn. Where we have to refuse a place because the preferred school is oversubscribed, pupils will be placed on a waiting list following an application. Once confirmation of your West Sussex address has been received, an alternative school place will be offered and the place previously offered by your Local Authority will be withdrawn.

Moving out of West Sussex to another county

Pupils moving out of West Sussex to another county must still apply through West Sussex prior to the deadline of 15 January 2018. Any preferences for out of county schools will be sent to the relevant authority for consideration.

It is advisable to contact your new Local Authority to discuss their process for moving and deadlines as they may not be the same as the ones for West Sussex.

Shared parental responsibility – duplicate and disputed applications

It is important to note that only one application can be processed for each child and only one offer of a school place made. Disputes on the preferred schools by those with parental responsibility should be settled between the parties, neither the Local Authority nor the admissions authority will become involved in any parental disputes. If a person with parental responsibility submits an application that is disputed by another person with parental responsibility or if more than one person with parental responsibility submits an application with different preferences then those applicants may need to settle the matter through the courts. Where no agreement is reached or court order obtained in time for the Local Authority to carry out its duties in accordance with the published timescales, the Local Authority will decide which application to process and will make only one offer of a school place. Failing to disclose information can result in a delay in offering a school place or an offer being withdrawn.

SEND Information, Advice and Support Service (SEND-IAS)

The SEND-IAS offers support to any parents who, for a variety of reasons, may have difficulties with the school application process. This includes helping parents formulate their thoughts when choosing the type of school that may be suitable for their child and supporting parents who may need assistance completing their application. For further information on this service contact: helpline on 0330 222 8555 (Mon.-Fri. 9am – 4pm), or by email: send.ias@westsussex.gov.uk

Looked after children or previously looked after children

Evidence is required to support applications for looked after children, or previously looked after children who ceased to be so because they were adopted, became subject to a special guardianship order, residence order or child arrangement order.

- Applications for looked after children, who are subject to a care order (under Section 31 of the Children Act 1989), should be made by the allocated social worker.
- Applications for previously looked after children who are adopted should be supported by a copy of the adoption certificate.
- Applications for previously looked after children who become subject to a special guardianship order (made under Section 14A of the Children Act 1989 - as amended by the Adoption and Children Act

2002) should be supported by a copy of the special guardianship order confirming the details of the arrangements for the child.

- Applications for previously looked after children who become subject to a residence order (made under Section 8 of the Children Act 1989) or child arrangement order (made under the Children and Families Act 2014) should be supported by a copy of the court order confirming the details of the arrangements for the child.

Private fostering arrangements

If you are caring for someone else's child for more than 28 days, you do not have parental responsibility for them and you are not a close relative such as a grandparent, brother, sister, uncle or aunt (whether full blood, half blood or by marriage or civil partnership) or step-parent, you may be private fostering. In such circumstances it is a legal requirement that you contact West Sussex County Council on: 01403 229900 or email: MASH@westsussex.gcsx.gov.uk

Applying under the exceptional and compelling category

Parents wishing to apply to church voluntary aided schools, foundation schools and academies (type of school is shown in the contact list pages 19-46), and schools in other local authority areas, on exceptional and compelling grounds should contact the school to discuss their child's needs and the school's oversubscription criteria as not all use this category.

Many, but not all, admission authorities have criteria where priority will be given to applicants if there is a strong medical case or exceptional need for the child to attend the school named first on their application. When considering applying under this category parents should bear in mind that all schools can cope with special educational needs such as Asperger Syndrome, Dyslexia etc.. Schools are also experienced in managing common childhood complaints such as asthma and allergies. Issues such as difficulties with childcare arrangements or the child's ability/school performance are not covered by this category.

Parents wishing to apply under this category must state in the additional information box for their first preference what independent professional evidence they are submitting to support their application. If this information is not provided in the additional information box, and the evidence is not received by the application deadline of **15 January 2018**, then the application will not be considered under the exceptional and compelling category but will be considered against the remaining admission criteria. The evidence must be sent to the Pupil Admissions Team and if posted sent by Recorded Delivery mail. The supporting evidence from the qualified professional (i.e. medical consultant or a psychologist) must explain clearly why it is essential for the child to attend the school named as their first preference. It must detail fully the child's needs and address the reason why these needs can only be met at the preferred school. Letters from parents alone are not sufficient nor are letters that do not address the question of which school the child must attend. Letters from teachers at the child's current school will not normally be taken into account.

The Pupil Admissions Team will not contact third parties to obtain information relating to an application. It is the parents' responsibility to send any evidence relating to their child to support their application. In the case of schools where admissions are decided by West Sussex County Council, a panel of Senior Officers will consider the supporting evidence and make a decision. Applications or evidence submitted late will only be considered in exceptional circumstances. Applications under this category can only be made when the preference is originally requested.

As priority under this category cannot be assumed, parents are strongly advised to name three different preferences. Doing so will not mean the first preference is treated with less consideration. Should priority not be given on the basis of the evidence submitted, the application will be considered against the remaining admission criteria, for example, residency within the catchment area. An application under this category can only be made as a first preference. If you apply under this category for a lower preference the application will be amended and only considered against the remaining admissions criteria.

Parents should be aware that the criteria for the exceptional and compelling category are **rarely met** and parents are advised to seek guidance from the relevant Admissions Authority regarding application under this category. All calls and any information received are treated in strict confidence. **In the 2017 starting school allocation, of the 19 applications considered by the panel only 2 proceeded on this basis.**

The application deadline, out of time and late applications

Your completed application must be submitted by the national application deadline of **Monday 15 January 2018**. The online system will close at 23:59 on Monday 15 January 2018. If you need to apply after this date, please telephone 03330 142 903 to request a paper form and return it to your local West Sussex primary school. Please note that the online system is not monitored after the deadline of Monday 15 January and, therefore, any changes to your details after the deadline must be notified to the Pupil Admissions Team by email or post.

If your application is received after the application deadline of 15 January 2018, between 16 January 2018 and 15 February 2018, it is out of time and your preferences will only be considered after all the applications received on time. Applications received on or after Friday 16 February 2018 are late, outside the normal admissions round, and will not be processed until after 15 May 2018.

Church voluntary aided schools, foundation schools and academies may deal with out of time and late applications in a different way – you should contact any of these schools if you make a preference for them after 15 January 2018, to establish how your application will be considered.

How places are allocated

All schools have a Published Admission Number (PAN) and oversubscription criteria that apply if there are more applications than places available. The PANs for all community and controlled, church aided and foundation primary schools and academies in West Sussex are shown on pages 19-46. The oversubscription criteria for all community and controlled primary schools in West Sussex are shown on page 47. The oversubscription criteria for all church aided and foundation schools and academies in West Sussex are available from the schools' websites and at www.westsussex.gov.uk/admissions.

Places will be allocated at all infant and primary schools to comply with Infant Class Size Legislation. This legislation restricts all Reception, Year 1 and Year 2 classes to a maximum of 30 pupils with one qualified teacher. If the 30th child admitted is a twin (or a child from a multiple birth) the other siblings may also be admitted to the school as permitted exceptions.

All your preferences will be considered at the same time against the oversubscription criteria applicable to the relevant school. In the case of oversubscription in any of the West Sussex County Council categories, priority is given to applicants who live nearest the school (measured by a straight line from school to the child's home address, using Ordnance Survey data within the curtilage of the property). Other tie-breaks may apply to church aided and foundation schools and academies.

All your preferences are equal and an admission authority cannot discriminate against an application simply because the school was not named first on an application. Every school that a parent names on their application is treated as if it were a separate application – each one is equal – and the highest possible preference that can be met will be offered. At allocation the Pupil Admissions Team determine which of the three preferences can and cannot be met. If more than one preference can be met then the order the preferences were listed on the application becomes relevant and a place is offered at the school listed as the higher preference. More information for parents on the Equal Preference System is available on the website.

If you wish to discuss the implications of the order of your preferences please contact the Pupil Admissions Team. We can only allocate a child one school place and any subsequent application and offer will result in the original offer being withdrawn.

Parents should note that children are not automatically considered for their catchment school and residing in a catchment area does not guarantee a place at the catchment school. Parents are strongly encouraged to include their catchment school as one of their three preferences.

Frequently Asked Questions

What is the role of the Pupil Admissions Team?

The role of the Pupil Admissions Team is to administer West Sussex County Council's coordinated admissions scheme, including the allocation of places at community and voluntary controlled schools in accordance with the Council's published admission policy. The Team is able to offer advice and guidance to parents making an application for their child. However, the Team is unable to:

- offer opinions on schools' suitability and performance;
- arrange visits to schools;
- allocate places outside West Sussex County Council's criteria or take account of personal circumstances, outside of exceptional and compelling cases;
- change a child's details (name or address) without written confirmation and acceptable supporting documentation where appropriate;
- investigate anonymous allegations regarding false addresses without sufficient information. West Sussex County Council does treat the issue of using a false address very seriously and any correspondence of this nature is dealt with confidentially.

If you are dissatisfied with the service of the Pupil Admissions Team, in the first instance please write to the Pupil Admissions Manager for the area, see page 58. Complaints about schools should be referred to the headteacher or the school's Governing Body.

How likely is it that my preference will be met?

Please see the section on using your three preferences wisely and being realistic (under 'Points to consider before submitting your three preferences') on page 5. The less priority you have under a school's oversubscription criteria the less likely you are to be offered a place if that school has more applications than places. For the 2017 starting school round 90.4% of parents who applied on time were offered their preferred school and 98.9% were offered one of their three preferred schools.

The table on pages 19-46 gives details about the number of places offered and children refused at each state-funded primary school in West Sussex for September 2017 admissions. This is only a guide because patterns of parental preference and the number of pupils in the area vary from year to year. The outcome of your application cannot be guaranteed. If you want further information about the previous patterns of admission to your preferred schools, please contact the Pupil Admissions Team.

Where can I find out information about schools?

It is important that you do not base your preferences on other people's opinions. Each school has a prospectus and website which include details of the school's policies, uniform, the curriculum and teaching methods, term dates and school times as well as other helpful information. You can obtain a copy of the prospectus from the school and you are welcome to make an appointment to visit the school. School websites can be accessed through the West Sussex County Council website. The Government website www.direct.gov.uk has links to school OFSTED reports and Department for Education performance tables. This information should also be available from the school or your local library.

Schools may invite you to attend an open session and this invitation or receipt of a prospectus should not be seen as an offer of a school place as all offers are made through the Local Authority. Headteachers may confirm that they would be happy to have your child in their school but again this is not an offer because all applications are subject to the admission criteria.

Are West Sussex Infant and Junior Schools linked?

West Sussex infant and junior schools are linked (see the lists on pages 32 and 46). If a starting school child will have a sibling at the junior school in September 2018, then the starting school child has sibling priority for the infant school. Please note that it is the parent's responsibility to tell the Pupil Admissions Team about sibling links in their application. When making the infant school application online do not tick the box '*Sibling will attend this school in September 2018*' but instead confirm their name, birthdate and school in the '*Additional Information*' box in the '*Reasons for this Preference*' section.

Please note that if you are applying for a Year 3 place for one child at the linked junior school and a Reception place for a sibling at the linked infant school you must still advise us of the sibling link on your younger child's application even though an offer for the Year 3 place will not yet be confirmed. The Pupil Admissions Team will then check your applications and ensure that the correct priority is given. If you do not advise us of the sibling link on your application it will not be given and your younger child will be disadvantaged. If you require any clarification on the process please contact the Pupil Admissions Team who will be happy to advise you.

Can I ask for my child to go to any primary school in West Sussex?

You can express a preference for any of the primary schools listed on pages 32 and 46. West Sussex County Council makes every effort to meet parental preference but some schools receive more applications than the number of places available. When this happens, the oversubscription criteria are used to decide which children are offered a place. Please also see the answer to the question 'How likely is it that my preference will be met?' on page 11 for further information, and advice on using your three preferences wisely and being realistic, on page 5.

Schools are categorised as community, controlled, church aided (sometimes called voluntary aided), foundation schools and academies. All community and voluntary controlled schools have catchment areas and West Sussex County Council determine and manage the admissions. You can check your catchment school by entering your postcode on our website.

Many church voluntary aided schools, foundation schools, free schools and academies also have catchment areas. In the case of church voluntary aided schools, the catchment area may be defined in terms of parishes or deaneries while others may serve an even wider area. For these schools, full details can be found in the school's published admission arrangements on their website. Decisions to offer a place at these schools are made by the Governing Body.

If you apply for a place for your child at a community or controlled school that is not the catchment school for your address, you should note the following:

- the Council will not provide assistance with travel or related expenses to the school;
- it is less likely that places will be available at oversubscribed schools for any brothers or sisters, should you wish them to attend at a later date;
- the tie break for oversubscribed schools, within any oversubscription category, is the straight line distance from home to school.

Can I defer my child's start at school?

By law, children must start their full-time education in the term following their fifth birthday. In West Sussex your child may start either full or part-time in the September following their fourth birthday. All applicants seeking admission during the academic year commencing in September 2018 must apply by the deadline **Monday 15 January 2018**.

When you have received the offer of a school place, you may wish to take the opportunity to discuss the school's induction arrangements and your child's start date with the school. You can defer admission until

the start of the spring or summer term so long as your child has not reached compulsory school age. However, you must inform the school of this decision.

You may feel that starting school in September 2018 is too early for your child and would prefer them to remain at a pre-school group, playgroup or in a nursery school. Should your child attend school part-time as well as a nursery or playgroup part-time, your Nursery Education Grant funding will automatically transfer to the school. This means you will have to pay the full fees for the amount of time your child attends nursery, pre-school or playgroup.

Should you choose to defer your child's start until the term following their fifth birthday; the school you have been offered will hold your child's school place provided your child is still joining the school in the reception year. If your child was born between 1 April 2014 and 31 August 2014 you can decide not to take up a school place until September 2019; however a place will not be held in a Reception class and in most cases your child may need to join Year 1 upon their admission to school. Parents wishing to defer to Year 1 must approach the Pupil Admission Team in June 2019 to apply for a place but should be aware that a place may not be available in a local school. For further advice on this matter, please contact the Pupil Admission Team.

Can I apply for admission outside my child's normal age group?

Parents may seek a place for their child outside of their normal age group. An application should be made to the Admission Authority for the school you wish to apply for. The decision will be made on the basis of the circumstances of each case and in the best interests of the child concerned. The right of appeal does not apply if a place is offered at the school but it is not in the preferred age group. For further information and advice please contact the Admissions Authority for the school you wish to apply for.

Can I delay starting school for my summer born child?

Parents wishing to educate their child outside of their normal age group are required to make a request to West Sussex County Council. A statement of our policy and relevant application form is available at: <https://www.westsussex.gov.uk/education-children-and-families/schools-and-colleges/school-places/admission-of-children-outside-their-normal-year-group/>.

If your child is born between 1st April and 31st August 2014 they will become of statutory school age in September 2019. The majority of parents of these summer born children are happy for their child to start school in September 2018 following their 4th birthday, however parents of children who were born prematurely and who would have naturally fallen into a lower age group if they had been born full-term may wish to request a delayed admission into Reception for their child.

Parents of summer born children may request that their child's entry into Reception be delayed until the following academic year. The decision lies with the relevant admission authority. For community and controlled schools this is West Sussex County Council, for an academy it is the academy trust and for a foundation or voluntary aided school it is the governing body. In order for the admission authority to make a decision, parents must complete a delayed entry application form, available on the West Sussex website, and should include any available evidence with their application from professionals detailing why there is a need for their child to start in the Reception class the following year. Applications should be returned to the Pupil Admissions Manager who will liaise with own admission authority schools regarding their decision. Any application for delaying entry must be submitted, along with any available professional evidence supporting the application, before the closing date of 15 January 2018. Applications or evidence submitted late will only be considered in exceptional circumstances and a decision will not be made until later in the summer term when any outstanding delayed entry requests are considered.

You must also complete an application, by 15 January 2018, for the admission of your child for September 2018 even if you are thinking of delaying entry until September 2019. Children develop at different rates and your child may change significantly between the application period and starting school. This will ensure that you have secured a school place for September 2018, which can be released later if the decision is made for your child to delay entry until 2019. Failure to make an application for September 2018 may result in your

child being offered a place at a school that is not one of your preferences and may be further away from your home.

If your application for delayed entry is agreed your child will not be allocated a place at a school for 2018 (or any place already offered will be released) and you will need to make a fresh application for a school place with those children starting school in September 2019. Parents should note that it will not be possible to apply online for a school place outside of your child's normal year of entry and you will need to contact the Pupil Admissions Team to request a paper application form in the autumn term 2018. The application will be considered in line with the published admission arrangements for the school alongside all other applications for September 2019.

If you are considering a delayed entry into school for your child you are strongly advised to contact the Pupil Admissions Team by email before applying to discuss the process and the implications for your child. Before making an application for delayed entry you must discuss your intentions with the schools that you are interested in as the local authority will be seeking the views of the headteacher of the schools you have made preferences for as part of their decision making.

If your application for delayed entry is refused, your child must either take up the place they have been offered for 2018 by the start of the summer term 2019 or you must make an application for a year 1 place in September 2019. Applications for Year 1 can be made in June 2019 for a September start. Parents should be aware that if their preferred school is full in Reception for 2018 it is unlikely that a place will be available in Year 1 in September 2019.

Important and detailed information regarding this process is available on the WSCC website.

Do special rules apply to twins and multiple births?

A separate application must be made for every child. Please note that sibling priority is only given when a sibling is already attending the school, therefore twins and multiple births do not give sibling priority to each other and their details should not be included as siblings on an application. Where West Sussex County Council is the Admissions Authority for the school and the last child to be offered a place is a twin, the other twin will normally be admitted over the published admission number. For schools that are their own admission authority please check their policy direct with the school.

What if my child has special educational needs?

The great majority of pupils with some form of special educational need participate fully in mainstream schools, with help appropriate to their special needs. This includes most children for whom the Council has issued a Statement of Special Educational Needs or an Education, Health and Care Plan (EHCP).

If your child has a Statement or EHCP, you have a right to make a request for a school and you should already have been contacted by the Special Educational Needs Assessment Team (SENAT). If not, please contact them using the contact details shown below. We try to arrange school admissions for children with Statements/EHCPs earlier in the year than other pupils to allow sufficient time to consider requests and for the necessary consultation process to take place.

If your child is in the process of an Education, Health and Care Assessment, you should still complete an application online with your mainstream school preferences. The Council will let you know whether an EHCP will be made and if a draft EHCP is issued you will be able to make a request for the school you would like your child to attend at that time. On rare occasions, if school allocations overlap with your child being assessed for an EHCP, you may receive an allocation from the Pupil Admissions Team which is different to the school you were expecting. Should this happen please contact the SENAT for advice; your child will be offered the school most appropriate to meet their needs.

Whilst we aim to meet parent requests where possible, it is the Council's responsibility to ensure placements are appropriate and are an efficient use of resources. Only children with a Statement of Special Educational Needs or EHCP/draft EHCP can apply for a place at a special school or a special support centre attached to a mainstream school.

If your child has a Statement of Special Educational Needs or EHCP/draft EHCP and you have any queries about the admission process, please contact SENAT using the following telephone numbers:

0330 222 8881: Chichester, Bognor Regis, Midhurst, Petworth

0330 222 8882: Angmering, Littlehampton, Steyning, Worthing, Shoreham, Lancing, Horsham West

0330 222 8883: Crawley, Burgess Hill, Horsham East, Haywards Heath, Cuckfield, East Grinstead

SENAT are located at Room 001, County Hall, Chichester, PO19 1RF.

(Please note that callers must report to the main reception desk)

email: sensupportteam@westsussex.gov.uk.

Please only contact SENAT if your child has a Statement of Special Educational Needs or EHCP/draft EHCP; for all other children admissions queries should be directed to the Pupil Admissions Team.

How do I apply to a church voluntary aided school or academy with a religious character?

You apply to a church voluntary aided school or academy with a religious character in the same way as you apply for a community or voluntary controlled school, foundation school or free school, i.e. you must complete an application through West Sussex County Council and return it online (applicants from outside West Sussex should follow their home Local Authority's application process).

For church voluntary aided schools and academies with a religious character, if you wish your application to be given priority on denominational grounds you must complete a supplementary information form (SIF) and return it direct to the school. SIFs can be obtained from the schools concerned. SIFs must be returned to the church voluntary aided school or academy with a religious character by the national application deadline which is Monday 15 January 2018.

If I live outside West Sussex, how do I apply for a West Sussex school?

Parents living outside West Sussex can apply for a school in this county but must do so by applying via their own Local Authority. This is the Local Authority for the county or city in which you live (telephone numbers for neighbouring local authorities are at the back of this booklet). You may wish to contact the Local Authority for your home to discuss the implications of listing a West Sussex school as a preference. Your home Local Authority will let us know about your application. Once decisions have been made we will inform your home Local Authority and they will notify you on 16 April 2018. The oversubscription criteria for all schools apply to all applicants, regardless of where they live.

Can I ask to go to a school outside West Sussex?

Parents living in West Sussex wishing to apply for a school place in another county or city must still apply online from the West Sussex website listing their preferences. We will tell the appropriate Local Authority about your application but you may find it helpful to contact them yourself to discuss your application. (Addresses and telephone numbers for neighbouring local authorities can be found at the back of this booklet). Once decisions have been made the appropriate Local Authority will let us know and we will notify you on **16 April 2018**.

Can I make alternative arrangements for my child's education?

You may decide to educate your child yourself at home. This is called Elective Home Education. It is important that the Pupil Admissions Team is aware of your plans, so that a place is not allocated unnecessarily for your child. Please confirm these alternative arrangements to the Pupil Admissions Team in writing. Your child will not then be allocated a school place. Please do not list Elective Home Education as a preference on an application as it will be disregarded and a school place offered. Please note that if you choose to educate your child yourself you do not receive any additional priority for a school place should you wish to apply at a later date.

Information regarding home education is available from West Sussex County Council's Elective Home Education Team on 0330 222 3300.

My child will be attending an independent school – do I still need to complete an application?

If you have received a confirmed offer of a place for your child at an independent school please confirm these arrangements to the Pupil Admissions Team in writing. Your child will not then be offered a state-funded school place. If your application to an independent school is still being considered and a place is yet to be formally offered, we recommend that you make an application online expressing three preferences for maintained schools in order to ensure your child has a school place for September 2018. If you are uncertain about your pending application to an independent school and would like further advice on making your application, please contact the Pupil Admissions Team for guidance. Please do not list an independent school as a preference on an application as it will be disregarded and a state school place offered.

Can I change my preference?

After the deadline you cannot change your preferences unless there is a genuine unforeseeable reason for doing so, for example, if a sibling has moved schools. Evidence of the change will be required. The processing deadline for the Pupil Admissions Team to receive confirmation of the change to allow it to be used for the purpose of allocating your child's school place is **Thursday 15 February 2018**. Before the national closing date of **15 January 2018** you can amend the preferences by logging back into your online application. **You must re-submit your application every time you make a change to your preferences.**

Only your last dated preferences, prior to the deadline, will be considered in the allocation.

When will I know if I have a place?

National offer day is **16 April 2018**. On time online applicants will be notified which school their child has been offered by email during the day. No decisions will be issued by telephone. Other applicants will be sent a letter by second class post, posted during the day.

What happens after allocation?

The majority of parents in West Sussex will receive an offer of a school place at a school they expressed a preference for. For children starting school for the first time, the school offered will ask you to accept the place and provide a copy of your council tax bill as proof of your address. **Accepting the place offered does not affect your right of appeal or to be on the waiting list for any school you have been refused.** If your address has or will be changing you must notify the Pupil Admissions Team without delay. The Headteacher of the school your child has been allocated will contact you to confirm the school's induction arrangements.

Different arrangements may apply for parents being offered school places in other Local Authority areas. If you have been offered a school in another Local Authority area you should contact the school to confirm the necessary arrangements for entry to the school.

What can I do if I am not offered a place at the school I wanted?

If we cannot offer your child a place at any of your preferred schools, we will offer a place at your catchment school if availability allows or, if your catchment school is full, you will be offered a place at the nearest school to your home address with a place available. (This only applies to children resident in West Sussex. If you live in another Local Authority's area they will offer you a place at one of their schools, if your preferences cannot be met). For this reason we always advise parents to include their child's catchment school as one of their three preferences. If you are unhappy with the school you have been offered The Pupil Admissions Team can tell you which alternative schools have places available but you should be aware these may be further from your home than the offer you currently have. Please note that we have a

statutory obligation to offer your child a school place and, therefore, we will not withdraw the place offered until we receive written confirmation of the alternative arrangements you have made for your child's education once they reach statutory school age.

Can I appeal?

You have the right to appeal against the decision not to offer a place at any of your preferred schools. All appeals are heard by an independent panel. If you have been refused a place in West Sussex at your preferred school(s) in writing, you can access an online appeal form and details of the appeals process at www.westsussex.gov.uk/education-children-and-families/schools-and-colleges/school-places/school-appeals-and-waiting-lists/. If you require a paper form you can download it from the website or ring 03330 142 903 to request one. If you decide to appeal, you will receive advance notice of the hearing date. You will be invited to attend the appeal and you may take someone with you for support. The hearing will be conducted as informally as possible and you will have the opportunity to put forward your case and ask questions.

For Reception, Year 1 and Year 2, the right of appeal is restricted by law due to Infant Class Size legislation. Where classes are organised in these year groups in classes of 30 pupils, you could only be successful if you could prove that:

- a) the admission arrangements were incorrectly applied in your case and your child should have been offered a place or
- b) the child would have been offered a place if the arrangements had not been contrary to mandatory provisions in the School Admissions Code or the law or
- c) the admission authority acted unreasonably – that is, the decision made was perverse and would not have been made by a reasonable authority.

If your appeal is refused, the Local Authority or Governing Body (at an academy, church voluntary aided school, foundation school or free school) will not consider a further application or appeal for a place at the same school, in the same academic year, unless there is a significant material change in your circumstances or those of the school.

Please note that appealing for a school place does not give priority on a waiting list. If you were refused a school place outside of West Sussex then you need to contact the Admissions Authority for the school refused for information on their appeal process.

Will my child's name be added to the waiting list?

If your child was refused a place in writing at a West Sussex school they will automatically be added to the waiting list for that school. Waiting lists are set-up 20 school days after the allocation date and will be held until 31 December. If you wish your child to remain on any list after this date you must confirm this in writing or by email to the Pupil Admissions Office in December. It is parent's responsibility to make contact with the Pupil Admissions Team – reminders will not be sent. If you have been refused a place at an Academy, Church Aided or Free School the waiting list will be held by the Admissions Team until September, when it will be passed to the school. From September you should contact the school directly regarding their management of the list. If you were refused a school place outside of West Sussex you need to contact the Local Authority for the school refused for information on their waiting list procedure.

All waiting lists are held in accordance with the School Admissions Code as required by the Department for Education. For example waiting lists must reflect the over-subscription criteria used at allocation and it is prohibited to prioritise lists using a date order. The oversubscription criteria for all Community and Voluntary Controlled schools in West Sussex are shown on page 47. A complete list of oversubscription criterion for all schools in West Sussex is detailed on our website. For Community and Voluntary Controlled schools, within each criterion waiting list positions are ordered by straight line distance to the school, the nearest having higher priority. If a place becomes available following the allocation it will be offered to the child at the top of the waiting list at that time.

What happens if my child can be offered a place from the waiting list?

If a place becomes available from a waiting list, you will be contacted using the information in your application. If we do not receive a reply from you within 5 working days of trying to contact you, your child's name will be removed from the waiting list and the place will be reallocated to the next child on that list. You may wish to provide additional contact information in order to ensure you can be contacted promptly in the event of a place becoming available. When doing so please ensure you consider your access to that route of contact i.e. can you access your emails whilst on holiday.

You should note we do not rank children on waiting lists until a place actually becomes available. At that time waiting lists are reviewed in accordance with the relevant school's over subscription criteria. The available place is then offered to the child at the top of the list at that time. The Admissions Team will only contact you regarding a waiting list if a place becomes available that can be offered to your child. We are unable to give any indication as to the likelihood of a place becoming available as spaces can only be allocated if children withdraw from a school's intake list. **For this reason we would ask that you do not contact the Pupil Admissions Team regarding waiting list positions.** Should you decide that you no longer want your child's name on a list please notify us as this will help prevent unnecessary delays in reallocating spaces should they become available. The team may contact parents as the academic year progresses to confirm if they wish their child's name to remain on a waiting list. This is to ensure the smooth operation of the lists and to avoid delays in allocating places should they become available.

Unless you are advised of an alternative school place, you should assume the place offer made for your child remains available and liaise with the school regarding their intake arrangements when they make contact with you.

Can I appeal for or put my child on a waiting list for a school that wasn't one of my original preferences?

If you wish to appeal or have your child placed on a waiting list for a school that was not one of your original preferences, you must first make an application for that school by completing an application form available at www.westsussex.gov.uk or calling 03330 142 903. Only when you have been refused a place in writing can you appeal and your child will be placed on the waiting list. Late applications are automatically added to the waiting list and we will confirm this when we write to you refusing you a place at the school

Contact List for all Primary Schools in the West Sussex Northern Area; including Academies, Church Voluntary Aided Schools, Community and Voluntary Controlled Schools, Foundation Schools and Free Schools.

- Map of the North/South areas is on page 59 of this booklet
- South area school are listed on pages 32-46

Name of School Headteacher Postal Address Telephone Number E-Mail Address Website DfE Number	School Type* (See pages 56-57 for definitions)	Age Range	Published Admission Number 2018/19	Number of Applications received before the deadline for 2017	Number of Places Offered at allocation date September 2017	How places were allocated for September 2017 as at allocation date (See oversubscription criteria)	Criteria & distance (in metres) of the last place allocated for September 2017 (for oversubscribed schools)
Albourne CE Primary Ms A Sturgeon The Street, Albourne, Hassocks, BN6 9DH (01273) 832003 office@albournecep.co.uk www.albournecep.co.uk 3060	Voluntary Controlled	4-11	30	23	27	All applicants who applied on time and requested this school were offered a place, plus 4 children who either applied late, didn't apply for a school place or whose preference for other schools could not be met and this was their catchment school or the nearest school with a place in the relevant year group.	
Ardingly St Peter's CE Primary Mr J Savage Holmans, Ardingly, RH17 6UQ (01444) 892314 office@st-peters.school www.st-peters-sch.uk 3050	Voluntary Controlled	4-11	20	21	20	Children with a statement: 0 Criterion 1: 0 Criterion 2: 0 Criterion 3: 8 Criterion 4: 5 Criterion 5: 2 Criterion 6: 5	Criterion: 6 6374.12
Balcombe CE Primary Mrs W Millbanks London Road, Balcombe, Haywards Heath, RH17 6HS (01444) 811403 office@balcombeschool.co.uk www.balcombeschool.co.uk 3051	Voluntary Controlled	4-11	20	16	16	All applicants who requested this school were offered places.	
Barns Green Primary Mr S Simmons The Hordens, Barns Green, Horsham, RH13 0PJ (01403) 730614 office@barnsgreen.org.uk www.barnsgreen.org.uk 2038	Community	4-11	20	20	20	All applicants who requested this school were offered places.	
Billingshurst Primary Miss H Williamson Station Road, Billingshurst, RH14 9RE (01403) 782789 office@billingshurstprimary.org.uk www.billingshurstprimary.org.uk 3376	Community	4-11	90	94	90	Children with a statement: 0 Criterion 1: 1 Criterion 2: 0 Criterion 3: 51 Criterion 4: 37 Criterion 5: 0 Criterion 6: 1	Criterion: 6 2367.51
Bolney CE Primary Mrs L Kenny Church Lane, Bolney, Haywards Heath, RH17 5QP (01444) 881352 office@bolneyprimary.school www.bolneyschool.org.uk 3052	Voluntary Controlled	4-11	16	15	15	All applicants who requested this school were offered places.	
Broadbridge Heath Shelley Primary Mr D Bird Wickhurst Lane, Broadbridge Heath, Horsham, RH12 3LU (01403) 265343 office@shelleyprimary.school www.shelleyprimary.school 2010	Community	4-11	60	64	60	Children with a statement: 0 Criterion 1: 0 Criterion 2: 0 Criterion 3: 22 Criterion 4: 38 Criterion 5: 0 Criterion 6: 0	Criterion: 4 942.14

Name of School Headteacher Postal Address Telephone Number E-Mail Address Website DfE Number	School Type* (See pages 56-57 for definitions)	Age Range	Published Admission Number 2018/19	Number of Applications received before the deadline for 2017	Number of Places Offered at allocation date September 2017	How places were allocated for September 2017 as at allocation date (See oversubscription criteria)	Criteria & distance (in metres) of the last place allocated for September 2017 (for oversubscribed schools)
Burgess Hill Birchwood Grove Community Primary Miss S White Birchwood Grove Road, Burgess Hill, RH15 0DP (01444) 242209 office@bwgschool.com www.birchwoodgrove.org.uk 2219	Community	4-11	60	102	60	Children with a statement: 1 Criterion 1: 1 Criterion 2: 0 Criterion 3: 18 Criterion 4: 22 Criterion 5: 12 Criterion 6: 6	Criterion: 6 823.22
Burgess Hill The Gattons Infant Miss K Hikmet Royal George Road, Burgess Hill, RH15 9SL (01444) 235071 office@thegattons.co.uk www.thegattons.co.uk 2214	Community	4-7	90	115	90	Children with a statement: 0 Criterion 1: 0 Criterion 2: 0 Criterion 3: 26 Criterion 4: 60 Criterion 5: 4 Criterion 6: 0	Criterion: 5 2472.93
Burgess Hill London Meed Community Primary Ms C J E Reece Chanctonbury Road, Burgess Hill, RH15 9YQ (01444) 232336 office@londonmeedprimary.co.uk www.londonmeedprimary.co.uk 2202	Community	4-11	60	65	60	Children with a statement: 0 Criterion 1: 0 Criterion 2: 0 Criterion 3: 13 Criterion 4: 20 Criterion 5: 11 Criterion 6: 16	Criterion: 6 1875.59
Burgess Hill Manor Field Primary Miss D Bailey Junction Road, Burgess Hill, RH15 0PZ (01444) 233368 office@manorfield.w-sussex.sch.uk www.manorfieldschool.org 2201	Community	4-11	90	64	83	All applicants who applied on time and requested this school were offered a place, plus 19 children who either applied late, didn't apply for a school place or whose preference for other schools could not be met and this was their catchment school or the nearest school with a place in the relevant year group.	
Burgess Hill Sheddingdean Community Primary Ms Y Ashraf Petworth Drive, Burgess Hill, RH15 8JT (01444) 246532 office@sheddingdean.co.uk www.sheddindeanschool.org.uk 2235	Community	4-11	30	24	30	All applicants who applied on time and requested this school were offered a place, plus 6 children who either applied late, didn't apply for a school place or whose preference for other schools could not be met and this was their catchment school or the nearest school with a place in the relevant year group.	
Burgess Hill St Wilfrid's Catholic Primary Mrs A O'Hara School Close, Queen Elizabeth Avenue, Burgess Hill, RH15 9RJ (01444) 235254 office@stwilfridsbh.org.uk www.st-wilfrids-burgesshill.w-sussex.sch.uk 3357	Church Voluntary Aided	4-11	60	86	60	Children with a statement: 0 Criterion 3: 16 Criterion 4: 20 Criterion 9: 5 Criterion 10: 7 Criterion 12: 1 Criterion 13: 7 Criterion 14: 4	Criterion: 14 449.91
Colgate Primary Mrs R Winn Blackhouse Road, Colgate, Horsham, RH13 6HS (01293) 851254 office@colgateprimary.org.uk www.colgate.eschools.co.uk/website 2015	Community	4-11	20	32	20	Children with a statement: 0 Criterion 1: 0 Criterion 2: 0 Criterion 3: 7 Criterion 4: 4 Criterion 5: 3 Criterion 6: 6	Criterion: 6 2190.28

Name of School Headteacher Postal Address Telephone Number E-Mail Address Website DfE Number	School Type* (See pages 56-57 for definitions)	Age Range	Published Admission Number 2018/19	Number of Applications received before the deadline for 2017	Number of Places Offered at allocation date September 2017	How places were allocated for September 2017 as at allocation date (See oversubscription criteria)	Criteria & distance (in metres) of the last place allocated for September 2017 (for oversubscribed schools)
Coolham William Penn Primary (Controlled) Mr S Kear Brooks Green Road, Coolham, Horsham, RH13 8GR (01403) 741274 office@williampenn.w-sussex.sch.uk www.williampenn.w-sussex.sch.uk 3042	Voluntary Controlled	4-11	15	10	11	All applicants who requested this school and applied on time were offered a place; 1 child who applied late was also offered a place.	
Copthorne Fairway Infant Mrs B Davison Fairway, Copthorne, Crawley, RH10 3QD (01342) 713691 office@fairway.w-sussex.sch.uk www.fairway.w-sussex.sch.uk 2218	Community	4-7	60	62	60	Children with a statement: 0 Criterion 1: 1 Criterion 2: 0 Criterion 3: 14 Criterion 4: 30 Criterion 5: 7 Criterion 6: 8	Criterion: 6 4477.70
Cowfold St Peter's CE Primary Mr G Kolter Potters Green, Station Road, Cowfold, Horsham, RH13 8QZ (01403) 864365 office@st-peters-cowfold.w-sussex.sch.uk www.stpetersce.eschools.co.uk 3309	Church Voluntary Aided	4-11	20	18	19	All applicants who requested this school and applied on time were offered a place; 1 child who applied late was also offered a place.	
Crawley Bewbush Academy (The) Mrs C Dickens Dorsten Square, Bewbush, Crawley RH11 8XW (01293) 534897 office@bewbushacademy.com www.bewbush-tkat.org 2004	Academy	4-11	90	88	90	Children with a statement: 0 Criterion 1: 0 Criterion 2: 0 Criterion 3: 33 Criterion 4: 28 Criterion 5: 11 Criterion 6: 18	Criterion: Late 6 467.95
Crawley Broadfield Primary Academy Mr D Tow Vulcan Close, Broadfield, Crawley RH11 9PD (01293) 406940 office@bpa-tkat.org www.bpa-tkat.org 2017	Academy	4-11	90	42	50	All applicants who applied on time and requested this school were offered a place, plus 8 children who either applied late, didn't apply for a school place or whose preference for other schools could not be met and this was their catchment school or the nearest school with a place in the relevant year group.	
Crawley Brook Infant (The) Miss F Dowley Salterns Road, Maidenbower, Crawley RH10 7JE (01293) 886521 office@brook.w-sussex.sch.uk www.brook.w-sussex.sch.uk 2254	Community	4-7	60	62	60	Children with a statement: 0 Criterion 1: 0 Criterion 2: 0 Criterion 3: 8 Criterion 4: 41 Criterion 5: 1 Criterion 6: 6 Criterion 7: 0 Criterion 8: 4	Criterion: 8 2682.58
Crawley Desmond Anderson Primary Academy Mrs K Elledge Anderson Road, Tilgate, Crawley, RH10 5EA (01293) 525596 office@desmondandersonprimaryacademy.org.uk www.desmondandersonprimaryacademy.org.uk 2244	Academy	4-11	60	84	60	Children with a statement: 0 Criterion 1: 1 Criterion 2: 0 Criterion 3: 22 Criterion 4: 31 Criterion 5: 5 Criterion 6: 1	Criterion: 6 458.50

Name of School Headteacher Postal Address Telephone Number E-Mail Address Website DfE Number	School Type* (See pages 56-57 for definitions)	Age Range	Published Admission Number 2018/19	Number of Applications received before the deadline for 2017	Number of Places Offered at allocation date September 2017	How places were allocated for September 2017 as at allocation date (See oversubscription criteria)	Criteria & distance (in metres) of the last place allocated for September 2017 (for oversubscribed schools)
Crawley Forge Wood Primary School Headteacher: Miss J Newton Somerley Drive, Crawley, RH10 3SW (01293) 850651 info@forgewoodschool.org www.forgewoodschool.org 2021	Academy	4-11	60	25	26	All applicants who requested this school were offered a place, plus 1 child who either didn't apply for a school place or whose preference for other schools could not be met and this was their catchment school or the nearest school with a place in the relevant year group.	
Crawley Gatwick School (The) Mr M Roessler 23 Gatwick Road, Crawley, RH10 9TP (01293) 538779 info@thegatwickschool.org.uk www.thegatwickschool.org.uk 4011	Free School	4-16	60	36	37	All applicants who requested this school and applied on time were offered a place; 1 child who applied late was also offered a place.	
Crawley Gossops Green Primary Mrs D Martin Kiddborough Road, Gossops Green, Crawley RH11 8HW (01293) 525449 office@gossopsgreen.com www.gossopsgreen.com 3361	Academy	4-11	90	80	82	All applicants who requested this school and applied on time were offered a place; 2 children who applied late were also offered a place.	
Crawley Hilltop Primary Mrs K Hollingdale Ditchling Hill, Southgate, Crawley, RH11 8QL (01293) 534314 office@hilltop-tkat.org www.hilltop-tkat.org 3363	Academy	4-11	90	96	90	Children with a statement: 0 Criterion 1: 0 Criterion 2: 0 Criterion 3: 9 Criterion 4: 23 Criterion 5: 34 Criterion 6: 24	Criterion: 6 1730.58
Crawley Langley Green Primary Mrs A Wallis Stagelands, Langley Green, Crawley, RH11 7PF (01293) 525675 office@lqprimary.org.uk www.langleygreenprimary.co.uk 3358	Community	4-11	60	51	56	All applicants who applied on time and requested this school were offered a place, plus 5 children who either applied late, didn't apply for a school place or whose preference for other schools could not be met and this was their catchment school or the nearest school with a place in the relevant year group.	
Crawley Maidenbower Infant Mrs S Harper Harvest Road, Maidenbower, Crawley, RH10 7RA (01293) 886324 office@maidenbowerinfant.w-sussex.sch.uk www.maidenbowerinfantschool.org.uk 2240	Community	4-7	90	109	90	Children with a statement: 0 Criterion 1: 0 Criterion 2: 0 Criterion 3: 20 Criterion 4: 41 Criterion 5: 11 Criterion 6: 15 Criterion 7: 3 Criterion 8: 0	Criterion: 7 1795.51
Crawley Mill Primary Academy (The) Mr N Small Ifield Drive, Ifield, Crawley, RH11 0EL (01293) 571893 office@themill-tkat.org www.millprimary.w-sussex.sch.uk 2020	Academy	4-11	90	48	49	All applicants who requested this school and applied on time were offered a place; 1 child who applied late was also offered a place.	

Name of School Headteacher Postal Address Telephone Number E-Mail Address Website DfE Number	School Type* (See pages 56-57 for definitions)	Age Range	Published Admission Number 2018/19	Number of Applications received before the deadline for 2017	Number of Places Offered at allocation date September 2017	How places were allocated for September 2017 as at allocation date (See oversubscription criteria)	Criteria & distance (in metres) of the last place allocated for September 2017 (for oversubscribed schools)
Crawley Milton Mount Primary Mrs A Holmes Grattons Drive, Pound Hill, Crawley, RH10 3AG (01293) 537158 office@miltonmount.co.uk www.miltonmount.co.uk 2176	Community	4-11	90	79	85	All applicants who applied on time and requested this school were offered a place, plus 6 children who either applied late, didn't apply for a school place or whose preference for other schools could not be met and this was their catchment school or the nearest school with a place in the relevant year group.	
Crawley Northgate Primary Mrs G Beaven Green Lane, Northgate, Crawley, RH10 8DX (01293) 526737 office@northgate.w-sussex.sch.uk www.northgate.w-sussex.sch.uk 3364	Community	4-11	90	62	66	All applicants who applied on time and requested this school were offered a place, plus 4 children who either applied late, didn't apply for a school place or whose preference for other schools could not be met and this was their catchment school or the nearest school with a place in the relevant year group.	
Crawley Oaks Primary (The) Mr A Gunn Loppets Road, Tilgate, Crawley, RH10 5DP (01293) 527473 office@oaks-tkat.org www.oaks-tkat.org 2250	Academy	4-11	60	91	60	Children with a statement: 0 Criterion 1: 0 Criterion 2: 0 Criterion 3: 21 Criterion 4: 39 Criterion 5: 0 Criterion 6: 0	Criterion: 4 1116.91
Crawley Our Lady Queen of Heaven Catholic Primary Mr T Melia Hare Lane, Langley Green, Crawley, RH11 7PZ (01293) 526057 office@olqoh.com www.olqoh.com 3338	Church Voluntary Aided	4-11	60	80	60	Children with a statement: 0 Criterion 2.4: 13 Criterion 2.5: 20 Criterion 4.5: 2 Criterion 6.4: 1 Criterion 6.5: 7 Criterion 7.4: 4 Criterion 7.5: 13	Criterion: 7.5 581.32
Crawley Pound Hill Infant Academy Mrs A Watson Crawley Lane, Pound Hill, Crawley RH10 7EB (01293) 873975 office@phiacademy.org.uk www.poundhillinfantacademy.org.uk 2150	Academy	4-7	90	144	90	Children with a statement: 0 Criterion 1: 1 Criterion 2: 0 Criterion 3: 20 Criterion 4: 64 Criterion 5: 5 Criterion 6: 0	Criterion: 5 912.83
Crawley Seymour Primary Miss S Park Seymour Road, Broadfield, Crawley, RH11 9ES (01293) 533198 office@seymour-tkat.org www.seymour-tkat.org 2139	Academy	4-11	90	74	79	All applicants who applied on time and requested this school were offered a place, plus 5 children who either applied late, didn't apply for a school place or whose preference for other schools could not be met and this was their catchment school or the nearest school with a place in the relevant year group.	
Crawley Southgate Primary Mr T O'Donoghue Barrington Road, Southgate, Crawley, RH10 6DG (01293) 525966 office@southgate.w-sussex.sch.uk www.southgateprimary.co.uk 3362	Community	4-11	60	51	60	All applicants who applied on time and requested this school were offered a place, plus 9 children who either applied late, didn't apply for a school place or whose preference for other schools could not be met and this was their catchment school or the nearest school with a place in the relevant year group.	

Name of School Headteacher Postal Address Telephone Number E-Mail Address Website DfE Number	School Type* (See pages 56-57 for definitions)	Age Range	Published Admission Number 2018/19	Number of Applications received before the deadline for 2017	Number of Places Offered at allocation date September 2017	How places were allocated for September 2017 as at allocation date (See oversubscription criteria)	Criteria & distance (in metres) of the last place allocated for September 2017 (for oversubscribed schools)
Crawley St Andrew's CE Primary Mrs D Packham Weald Drive, Furnace Green, Crawley, RH10 6NU (01293) 529006 office@st-andrews-crawley.w-sussex.sch.uk www.st-andrews-crawley.w-sussex.sch.uk 3341	Church Voluntary Aided	4-11	30	30	30	Children with a statement: 0 Criterion 1: 0 Criterion 2: 3 Criterion 3: 1 Criterion 4: 10 Criterion 5: 16	Criterion: 5 4146.12
Crawley St Francis of Assisi Catholic Primary School Mr T Hallett Southgate Drive, Southgate, Crawley RH10 6HD (01293) 521009 office@st-francisassisi.w-sussex.sch.uk www.stfranciscrawley.org 3340	Church Voluntary Aided	4-11	60	68	60	Children with a statement: 0 Criterion 1: 0 Criterion 2: 55 Criterion 3: 0 Criterion 4: 0 Criterion 5: 0 Criterion 6: 1 Criterion 7: 4 Criterion 8: 0	Criterion: 7 631.69
Crawley St Margaret's CE Primary Mrs J Hine The Mardens, Ifield, Crawley, RH11 0AQ (01293) 521077 office@st-margaretsifield.w-sussex.sch.uk www.st-margaretsifield.w-sussex.sch.uk 3335	Church Voluntary Aided	4-11	60	42	43	All applicants who requested this school and applied on time were offered a place; 1 child who applied late was also offered a place.	
Crawley Three Bridges Primary Mrs T Emberson Gales Place, Three Bridges, Crawley, RH10 1QG (01293) 524076 Lower Site: office@threebridgesprimary.school.co.uk www.threebridgesprimary.school.co.uk 2153	Community	4-11	90	83	90	All applicants who applied on time and requested this school were offered a place, plus 7 children who either applied late, didn't apply for a school place or whose preference for other schools could not be met and this was their catchment school or the nearest school with a place in the relevant year group.	
Crawley Waterfield Primary Miss K Gilzene Waterfield Gardens, Bewbush, RH11 8RA (01293) 548014 office@waterfield.w-sussex.sch.uk www.waterfieldprimary.co.uk 2230	Community	4-11	60	42	42	All applicants who requested this school were offered a place.	
Crawley West Green Primary Mr A Hodgson West Green Drive, West Green, Crawley, RH11 7EL (01293) 526679 admin@westgreenprimary.com www.westgreen.w-sussex.sch.uk 2018	Community	4-11	30	35	30	Children with a statement: 0 Criterion 1: 0 Criterion 2: 0 Criterion 3: 11 Criterion 4: 19 Criterion 5: 0 Criterion 6: 0	Criterion: 4 521.35
Crawley Down Village CE Primary Mr O Burcombe Hophurst Drive, Crawley Down, Crawley, RH10 4XA (01342) 713292 office@crawleydownschool.com www.crawleydownschool.com 3366	Voluntary Controlled	4-11	60	51	52	All applicants who requested this school were offered a place, plus 1 child who either didn't apply for a school place or whose preference for other schools could not be met and this was their catchment school or the nearest school with a place in the relevant year group.	

Name of School Headteacher Postal Address Telephone Number E-Mail Address Website DfE Number	School Type* (See pages 56-57 for definitions)	Age Range	Published Admission Number 2018/19	Number of Applications received before the deadline for 2017	Number of Places Offered at allocation date September 2017	How places were allocated for September 2017 as at allocation date (See oversubscription criteria)	Criteria & distance (in metres) of the last place allocated for September 2017 (for oversubscribed schools)
Cuckfield Holy Trinity CE (Aided) Primary Mrs A Macgregor Glebe Road, Cuckfield, Haywards Heath, RH17 5BE (01444) 454295 office@htprimary.co.uk www.holytrinity-cuckfield.w-sussex.sch.uk 3350	Church Voluntary Aided	4-11	60	46	49	All applicants who applied on time and requested this school were offered a place, plus 3 children who either applied late, didn't apply for a school place or whose preference for other schools could not be met and this was their catchment school or the nearest school with a place in the relevant year group.	
East Grinstead Ashurst Wood Primary Mrs L Hobby School Lane, Ashurst Wood, East Grinstead, RH19 3QW (01342) 822584 office@ashurstwood.w-sussex.sch.uk www.ashurstwoodprimary.co.uk 2200	Community	4-11	20	17	17	All applicants who requested this school were offered a place.	
East Grinstead Baldwins Hill Primary Mrs S Martin Lowdells Lane, East Grinstead, RH19 2AP (01342) 321572 officebh@grenestede.co.uk www.baldwinhillprimaryschool.co.uk 2247	Academy	4-11	30	20	20	All applicants who requested this school were offered a place.	
East Grinstead Blackwell Primary Ms P Crocker Blackwell Farm Road, East Grinstead, RH19 3JL (01342) 323906 office@blackwellpri.co.uk www.blackwell.w-sussex.sch.uk 2241	Community	4-11	60	52	52	All applicants who requested this school were offered a place.	
East Grinstead Estcots Primary Mrs R Brock Bourg de Peage Avenue, East Grinstead, RH19 3TY (01342) 327473 office@estcots.co.uk www.estcots.co.uk 2220	Community	4-11	60	57	59	All applicants who applied on time and requested this school were offered a place, plus 2 children who either applied late, didn't apply for a school place or whose preference for other schools could not be met and this was their catchment school or the nearest school with a place in the relevant year group.	
East Grinstead Halsford Park Primary Mrs C Spencer Manor Road, East Grinstead, RH19 1LR (01342) 324643 officehp@grenestede.co.uk www.halsfordparkprimaryschool.co.uk 2210	Academy	4-11	60	59	60	All applicants who requested this school and applied on time were offered a place; 1 child who applied late was also offered a place.	
East Grinstead Meads Primary (The) Mrs R Perry Mill Way, East Grinstead, RH19 4DD (01342) 322905 office@meads.w-sussex.sch.uk www.meads.w-sussex.sch.uk 2242	Community	4-11	45	46	45	Children with a statement: 1 Criterion 1: 0 Criterion 2: 0 Criterion 3: 13 Criterion 4: 12 Criterion 5: 9 Criterion 6: 10	Criterion: 6 1874.32

Name of School Headteacher Postal Address Telephone Number E-Mail Address Website DfE Number	School Type* (See pages 56-57 for definitions)	Age Range	Published Admission Number 2018/19	Number of Applications received before the deadline for 2017	Number of Places Offered at allocation date September 2017	How places were allocated for September 2017 as at allocation date (See oversubscription criteria)	Criteria & distance (in metres) of the last place allocated for September 2017 (for oversubscribed schools)
East Grinstead St Mary's CE Primary Miss R Thorne Windmill Lane, East Grinstead, RH19 2DS (01342) 323858 office@stmaryseg.co.uk www.stmaryseg.co.uk 3351	Church Voluntary Aided	4-11	30	28	28	All applicants who requested this school were offered a place.	
East Grinstead St Peter's Catholic Primary Mrs M J Claffey Chapmans Lane, East Grinstead, RH19 1JB (01342) 321985 office@stpeterseg.co.uk www.stpeterseastgrinstead.co.uk 3356	Church Voluntary Aided	4-11	30	27	27	All applicants who requested this school were offered a place.	
Handcross Primary School Mrs G Pedersen London Road, Handcross, Haywards Heath, RH17 6HB (01444 400291) office@handcross.w-sussex.sch.uk www.handcross.w-sussex.sch.uk 2205	Community	4-11	30	45	30	Children with a statement: 0 Criterion 1: 0 Criterion 2: 0 Criterion 3: 15 Criterion 4: 9 Criterion 5: 5 Criterion 6: 1	Criterion: 6 2226.57
Hassocks Infant Mrs J Hughes Chancellors Park, Hassocks, BN6 8EY (01273) 842549 Office@hassocksis.com www.hassocks.w-sussex.sch.uk 2206	Community	4-7	90	107	90	Children with a statement: 0 Criterion 1: 0 Criterion 2: 0 Criterion 3: 37 Criterion 4: 53 Criterion 5: 0 Criterion 6: 0	Criterion: 4 744.44
Haywards Heath Bolnore Village Primary Mrs S Allen Updown Hill, Bolnore Village, Haywards Heath, RH16 4GD (01444) 456715 office@bolnoreschool.co.uk www.bolnorevillage.w-sussex.sch.uk 3372	Foundation	4-11	60	49	49	All applicants who requested this school were offered places	
Haywards Heath Harlands Primary Mrs J E Goodlace Penland Road, Haywards Heath, RH16 1PJ (01444) 450782 office@harlandstedtrust.org.uk www.harlandspriamaryschool.org 2212	Academy	4-11	60	56	58	All applicants who requested this school were offered a place, plus 2 children who either didn't apply for a school place or whose preference for other schools could not be met and this was their catchment school or the nearest school with a place in the relevant year group.	
Haywards Heath Northlands Wood Community Primary Mr G Oulton Beech Hill, Northlands Wood Estate, Haywards Heath, RH16 3RX (01444) 455653 office@northlandswood.co.uk www.northlandswood.co.uk 2223	Community	4-11	60	58	60	All applicants who requested this school and applied on time were offered a place; 2 children who applied late were also offered a place.	
Haywards Heath St Joseph's Catholic Primary Mrs C Walker Hazelgrove Road, Haywards Heath, RH16 3PQ (01444) 452584 office@stjosephshh.org.uk www.stjosephshh.org.uk 3355	Church Voluntary Aided	4-11	60	65	60	Children with a statement: 0 Criterion 2: 21 Criterion 3: 26 Criterion 7: 3 Criterion 9: 3 Criterion 10: 5 Criterion 11: 2	Criterion: 11 392.37

Name of School Headteacher Postal Address Telephone Number E-Mail Address Website DfE Number	School Type* (See pages 56-57 for definitions)	Age Range	Published Admission Number 2018/19	Number of Applications received before the deadline for 2017	Number of Places Offered at allocation date September 2017	How places were allocated for September 2017 as at allocation date (See oversubscription criteria)	Criteria & distance (in metres) of the last place allocated for September 2017 (for oversubscribed schools)
Haywards Heath St Wilfrid's CE Primary Mrs P Cripps Eastern Road, Haywards Heath, RH16 3NL (01444) 413707 office@st-wilfrids-haywards-heath.w-sussex.sch.uk www.st-wilfrids-haywards-heath.w-sussex.sch.uk 3352	Church Voluntary Aided	4-11	60	46	53	All applicants who applied on time and requested this school were offered a place, plus 7 children who either applied late, didn't apply for a school place or whose preference for other schools could not be met and this was their catchment school or the nearest school with a place in the relevant year group.	
Haywards Heath Warden Park Primary Academy Mr S Davis New England Road, Haywards Heath, RH16 3JR (01444) 451264 office@wardenparkprimary.co.uk www.wardenparkprimary.co.uk 2001	Academy	4-11	60	60	60	Children with a statement: 0 Criterion 1: 0 Criterion 2: 0 Criterion 3: 20 Criterion 4: 35 Criterion 5: 1 Criterion 6: 4	Criterion: 6 1398.43
Horsham All Saints CE Primary Mrs S Costa Tylden Way, Horsham, RH12 5JB (01403) 270460 admin@allsaintshorsham.school www.allsaints.w-sussex.sch.uk 2259	Church Voluntary Aided	4-11	30	39	30	F1: 0 C2: 12 F2: 1 C3: 3 F3: 0 F4: 7 F5: 5 F6: 0 F7: 2 F8: 0 F9: 0 F10: 0	F7: 934.47 C3: 194.72
Horsham Arunside Primary Mr R Roberts Blackbridge Lane, Horsham, RH12 1RR (01403) 263919 office@arunside.school www.arunside.w-sussex.sch.uk 2124	Community	4-11	60	46	53	All applicants who applied on time and requested this school were offered a place, plus 7 children who either applied late or whose preference for other schools could not be met and this was their catchment school or the nearest school with a place in the relevant year group.	
Horsham Heron Way Primary Mr J Crump Heron Way, Horsham, RH13 6DJ (01403) 261944 office@heronway.org.uk www.heronway.w-sussex.sch.uk 2133	Community	4-11	60	74	60	Children with a statement: 0 Criterion 1: 0 Criterion 2: 0 Criterion 3: 19 Criterion 4: 12 Criterion 5: 9 Criterion 6: 20	Criterion: 6 1825.88
Horsham Holbrook Primary Mr I Holmes Holbrook School Lane, Horsham, RH12 5PP (01403) 272500 office@holbrookprimaryschool.com www.holbrookschool.co.uk 2243	Community	4-11	60	69	60	Children with a statement: 0 Criterion 1: 0 Criterion 2: 0 Criterion 3: 11 Criterion 4: 18 Criterion 5: 11 Criterion 6: 20	Criterion: 6 1327.45
Horsham Kingslea Primary Mr A Conway King's Road, Horsham, RH13 5PS (01403) 254282 office@kingslea.org.uk www.kingslea.w-sussex.sch.uk 3365	Community	4-11	60	84	60	Children with a statement: 0 Criterion 1: 0 Criterion 2: 0 Criterion 3: 21 Criterion 4: 30 Criterion 5: 6 Criterion 6: 3	Criterion: 6 719.94

Name of School Headteacher Postal Address Telephone Number E-Mail Address Website DfE Number	School Type* (See pages 56-57 for definitions)	Age Range	Published Admission Number 2018/19	Number of Applications received before the deadline for 2017	Number of Places Offered at allocation date September 2017	How places were allocated for September 2017 as at allocation date (See oversubscription criteria)	Criteria & distance (in metres) of the last place allocated for September 2017 (for oversubscribed schools)
Horsham Leechpool Primary Mrs N Davenport Leechpool Lane, Horsham, RH13 6AG (01403) 210233 office@leechpool.w-sussex.sch.uk www.leechpoolprimaryschool.co.uk 2182	Community	4-11	60	59	60	Children with a statement: 0 Criterion 1: 0 Criterion 2: 0 Criterion 3: 13 Criterion 4: 13 Criterion 5: 23 Criterion 6: 11	Criterion: Late 3 643.45
Horsham Littlehaven Infant Mrs S Anderson Hawkesbourne Road, Horsham, RH12 4EH (01403) 260608 Office@littlehaven.w-sussex.sch.uk www.littlehaven.w-sussex.sch.uk 2037	Community	4-7	45	29	34	All applicants who applied on time and requested this school were offered a place, plus 5 children who either applied late or whose preference for other schools could not be met and this was their catchment school or the nearest school with a place in the relevant year group.	
Horsham North Heath Community Primary Mr M J Gildea Erica Way, Horsham, RH12 5XL (01403) 254790 office@northheathprimary.co.uk www.northheathprimary.co.uk 2225	Community	4-11	60	61	60	Children with a statement: 0 Criterion 1: 0 Criterion 2: 0 Criterion 3: 26 Criterion 4: 13 Criterion 5: 9 Criterion 6: 12	Criterion: 6 3298.06
Horsham St John's Catholic Primary Mrs T Bono Blackbridge Lane, Horsham, RH12 1RR (01403) 265447 office@stjohnshorsham.school www.stjohnshorsham.school 3331	Church Voluntary Aided	4-11	30	20	21	All applicants who requested this school were offered a place, plus 1 child who either didn't apply for a school place or whose preference for other schools could not be met and this was their catchment school or the nearest school with a place in the relevant year group.	
Horsham St Mary's CE Primary Mr A Bird Normandy, Horsham, RH12 1JL (01403) 265999 office@st-marys-horsham.w-sussex.sch.uk www.stmarysschoolhorsham.co.uk 3315	Church Voluntary Aided	4-11	30	41	30	Children with a statement: 0 LAC: 1 Criterion 1: 0 Criterion 2: 10 Criterion 3: 0 Criterion 4: 3 Criterion 5: 2 Criterion 6: 8 Criterion 7: 1 Criterion 8: 4 Criterion 9: 1	Criterion: 9 270.44
Horsham St Robert Southwell Catholic Primary Mr J Field Lambs Farm Road, Horsham, RH12 4LP (01403) 252357 office@st-robertsouthwell.w-sussex.sch.uk www.st-robertsouthwell.co.uk 3349	Church Voluntary Aided	4-11	30	31	30	Children with a statement: 0 Criterion 1: 0 Criterion 2: 18 Criterion 3: 2 Criterion 4: 0 Criterion 5: 0 Criterion 6: 1 Criterion 7: 0 Criterion 8: 1 Criterion 9: 0 Criterion 10: 8	Criterion: 10 4404.03
Horsham Trafalgar Infant Miss K Green Victory Road, Horsham RH12 2JF (01403) 254925 office@trafalgarinfant.com www.trafalgarinfant.com 2035	Community	4-7	90	99	90	Children with a statement: 0 Criterion 1: 0 Criterion 2: 0 Criterion 3: 9 Criterion 4: 55 Criterion 5: 13 Criterion 6: 13	Criterion: 6 1480.05

Name of School Headteacher Postal Address Telephone Number E-Mail Address Website DfE Number	School Type* (See pages 56-57 for definitions)	Age Range	Published Admission Number 2018/19	Number of Applications received before the deadline for 2017	Number of Places Offered at allocation date September 2017	How places were allocated for September 2017 as at allocation date (See oversubscription criteria)	Criteria & distance (in metres) of the last place allocated for September 2017 (for oversubscribed schools)
Horsted Keynes St Giles CE Primary Mrs H Douch Church Lane, Horsted Keynes, Haywards Heath, RH17 7AY (01825) 790240 office@stgilesprimary.co.uk www.st-giles.w-sussex.sch.uk 3353	Church Voluntary Aided	4-11	22	14	14	All applicants who requested this school were offered a place.	
Hurstpierpoint St Lawrence CE Primary Mr P Dyer Trinity Road, Hurstpierpoint, BN6 9UY (01273) 833229 office@stlawrencehurst.co.uk www.stlawrencehurst.co.uk 3354	Church Voluntary Aided	4-11	90	104	90	Children with a statement: 0 Criterion 2: 39 Criterion 3: 4 Criterion 4: 2 Criterion 6: 39 Criterion 7: 5 Criterion 9: 1	Criterion: 9 4871.57
Lindfield Blackthorns Primary Academy Mrs M Brand 3 Blackthorns Close, Lindfield, Haywards Heath, RH16 2UA (01444) 454866 office@blackthornsprimaryacademy.org.uk www.blackthornsprimaryacademy.org.uk 2221	Academy	4-11	30	50	30	Children with a statement: 0 Criterion 1: 1 Criterion 2: 0 Criterion 3: 12 Criterion 4: 16 Criterion 5: 1 Criterion 6: 0	Criterion: 5 2361.55
Lindfield Lindfield Primary Academy Mr M Still School Lane, Lindfield, Haywards Heath, RH16 2DX (01444) 482524 office@lindfieldprimaryacademy.org.uk www.lindfieldprimaryacademy.org.uk 2257	Academy	4-11	90	112	91* (*The last place offered was to a twin)	Children with a statement: 0 Criterion 1: 0 Criterion 2: 0 Criterion 3: 43 Criterion 4: 34 Criterion 5: 3 Criterion 6: 6 Criterion 7: 5 Criterion 8: 0	Criterion: 7 3637.28
Lower Beeding Holy Trinity CE Primary Mrs T Bishop Church Close, Lower Beeding, Horsham, RH13 6NS (01403) 891263 office@holytrinity-horsham.w-sussex.sch.uk www.holytrinity-horsham.w-sussex.sch.uk 3022	Voluntary Controlled	4-11	13	15	13	Children with a statement: 0 Criterion 1: 0 Criterion 2: 0 Criterion 3: 2 Criterion 4: 5 Criterion 5: 4 Criterion 6: 2	Criterion: 6 3140.17
Loxwood Primary Ms P Kitson Nicholsfield, Loxwood, Billingshurst, RH14 0SR (01403) 752207 office@htlb.school www.loxwoodschoo.com 2046	Community	4-11	25	30	30* (*30 places were offered in line with plans to expand the PAN to 30 in future years)	All applicants who requested this school were offered a place.	
Nuthurst St Andrew's CE Primary Mr N Golbey Nuthurst Street, Nuthurst, Horsham, RH13 6LH (01403) 891286 office@st-andrews-horsham.w-sussex.sch.uk www.st-andrews-horsham.w-sussex.sch.uk 3317	Church Voluntary Aided	4-11	20	9	10	All applicants who requested this school and applied on time were offered a place; 1 child who applied late was also offered a place.	

Name of School Headteacher Postal Address Telephone Number E-Mail Address Website DfE Number	School Type* (See pages 56-57 for definitions)	Age Range	Published Admission Number 2018/19	Number of Applications received before the deadline for 2017	Number of Places Offered at allocation date September 2017	How places were allocated for September 2017 as at allocation date (See oversubscription criteria)	Criteria & distance (in metres) of the last place allocated for September 2017 (for oversubscribed schools)
Plaistow & Kirdford Primary Mr C King Loxwood Road, Plaistow, Billingshurst, RH14 0PX (01403) 871275 office@plaistowkirdford.com www.plaistowandkirdfordschool.co.uk 2050	Community	4-11	30	22	23	All applicants who requested this school were offered a place, plus 1 child who either didn't apply for a school place or whose preference for other schools could not be met and this was their catchment school or the nearest school with a place in the relevant year group.	
Pulborough St Mary's CE Aided Primary Mrs J Brown Link Lane, Pulborough, RH20 2AN (01798) 872007 office@st-marys-pulborough.w-sussex.sch.uk www.st-marys-pulborough.w-sussex.sch.uk 3342	Church Voluntary Aided	4-11	60	44	46	All applicants who requested this school and applied on time were offered a place; 2 children who applied late were also offered a place.	
Rudgwick Primary Miss A Bowers Tates Way, Rudgwick, Horsham, RH12 3HW (01403) 822151 office@rudgwick.w-sussex.sch.uk www.rudgwickprimaryschool.org.uk 2051	Community	4-11	30	33	30	Children with a statement: 0 Criterion 1: 1 Criterion 2: 0 Criterion 3: 9 Criterion 4: 14 Criterion 5: 6 Criterion 6: 0	Criterion: 5 15,824.0
Rusper Primary Mr N Avey Horsham Road, Rusper, Horsham, RH12 4PR (01293) 871272 office@rusper.w-sussex.sch.uk www.rusperprimary.eschools.co.uk 2052	Community	4-11	15	16	16* (*The last place offered was to a twin)	Children with a statement: 0 Criterion 1: 0 Criterion 2: 0 Criterion 3: 7 Criterion 4: 4 Criterion 5: 1 Criterion 6: 4	Criterion: 6 8706.42
Scaynes Hill St Augustine's CE Primary Mrs C Tilney Vicarage Lane, Scaynes Hill, Haywards Heath, RH17 7PB (01444) 831371 office@st-augustines.school www.st-augustines.w-sussex.sch.uk 3055	Voluntary Controlled	4-11	15	14	14	All applicants who requested this school were offered a place.	
Shipley CE Primary Mrs J Harvey School Lane, Shipley, Horsham, RH13 8PL (01403) 741298 office@shipley.w-sussex.sch.uk www.shipleyceprimary.com 3028	Voluntary Controlled	4-11	12	15	12	Children with a statement: 0 Criterion 1: 0 Criterion 2: 0 Criterion 3: 3 Criterion 4: 2 Criterion 5: 3 Criterion 6: 4	Criterion: 6 5239.12
Slinfold CE Primary Miss L Phibbs The Street, Slinfold, Horsham, RH13 0RR (01403) 790253 office@slinfold.w-sussex.sch.uk www.slinfold.w-sussex.sch.uk 3031	Voluntary Controlled	4-11	20	19	19	All applicants who requested this school were offered places.	
Southwater Castlewood Primary Ms R Nunns Castlewood Road, Southwater, Horsham, RH13 9US (01403) 734822 office@castlewoodprimary.co.uk www.castlewood.w-sussex.sch.uk 2249	Community	4-11	30	27	28	All applicants who requested this school and applied on time were offered a place; 1 child who applied late was also offered a place.	

Name of School Headteacher Postal Address Telephone Number E-Mail Address Website DfE Number	School Type* (See pages 56-57 for definitions)	Age Range	Published Admission Number 2018/19	Number of Applications received before the deadline for 2017	Number of Places Offered at allocation date September 2017	How places were allocated for September 2017 as at allocation date (See oversubscription criteria)	Criteria & distance (in metres) of the last place allocated for September 2017 (for oversubscribed schools)
Southwater Infant Academy Mrs S Winn Worthing Road, Southwater, Horsham, RH13 9JH (01403) 733254 office@southwaterinfants.co.uk www.southwaterinfantacademy.co.uk 2136	Academy	4-7	120	83	83	All applicants who requested this school were offered a place.	
Staplefield St Mark's CE Primary Ms L Kelsey Brantridge Lane, Staplefield, Haywards Heath, RH17 6EN (01444) 400398 office@st-marks.w-sussex.sch.uk www.st-marks.w-sussex.sch.uk 3061	Voluntary Controlled	4-11	15	16	15	Children with a statement: 0 Criterion 1: 0 Criterion 2: 0 Criterion 3: 1 Criterion 4: 2 Criterion 5: 3 Criterion 6: 9	Criterion: 6 6374.12
Turners Hill CE Primary Mr B Turney Church Road, Turners Hill, Crawley, RH10 4PA (01342) 715412 office@turnershillschool.org.uk www.turnershillschool.org.uk 3056	Voluntary Controlled	4-11	20	29	20	Children with a statement: 0 Criterion 1: 0 Criterion 2: 0 Criterion 3: 6 Criterion 4: 11 Criterion 5: 1 Criterion 6: 2	Criterion: 6 3942.14
Twineham CE Primary Mr S Reece Church Lane, Twineham, Haywards Heath, RH17 5NR (01444) 881207 office@twineham.w-sussex.sch.uk www.twineham.w-sussex.sch.uk 3057	Voluntary Controlled	4-11	15	21	16* (*The last place offered was to a twin)	Children with a statement: 0 Criterion 1: 0 Criterion 2: 0 Criterion 3: 1 Criterion 4: 2 Criterion 5: 6 Criterion 6: 7	Criterion: 6 3005.22
Warnham CE Primary Mrs J Costello Freeman Road, Warnham, Horsham, RH12 3RQ (01403) 265230 office@warnhamprimary.co.uk www.warnhamschool.org.uk 3037	Voluntary Controlled	4-11	30	36	30	Children with a statement: 0 Criterion 1: 1 Criterion 2: 0 Criterion 3: 2 Criterion 4: 7 Criterion 5: 11 Criterion 6: 9	Criterion: 6 3135.76
Warninglid Primary School Mrs M West Slaugham Lane, Warninglid, Haywards Heath, RH17 5TJ (01444) 461329 officeadmin@warninglidprimary.co.uk www.warninglid.w-sussex.sch.uk 2209	Community	4-11	10	3	3	All applicants who requested this school were offered a place.	
West Hoathly CE Primary School (Controlled) Mr A Earle North Lane, West Hoathly, East Grinstead, RH19 4QG (01342) 810302 office@westhoathlyschool.co.uk www.westhoathlyschool.co.uk 3058	Voluntary Controlled	4-11	20	14	14	All applicants who requested this school were offered places.	
Wisborough Green Primary School Mrs A Harrison Newpound Lane, Wisborough Green, Billingshurst, RH14 0EE (01403) 700280 office@wisboroughgreenschool.org.uk www.wisboroughgreenschool.org.uk 2073	Community	4-11	30	28	28	All applicants who requested this school were offered places.	

Linked Infant/Junior Schools in the Northern Area – for sibling link purposes

Burgess Hill, The Gattons Infant School	Burgess Hill, Southway Junior School
Copthorne, Fairway Infant School	Copthorne, Copthorne CE Junior School
Crawley, The Brook Infant School	Crawley, Maidenbower Junior School
Crawley, Maidenbower Infant School	Crawley, Maidenbower Junior School
Crawley, Pound Hill Infant Academy	Crawley, Pound Hill Junior School
Hassocks, Hassocks Infant School	Hassocks, The Windmills Junior School
Horsham, Littlehaven Infant School	Horsham, Northolmes Junior School

Contact List for all Community, Controlled, Church Aided and Foundation Schools and Academies in the Southern Area

- Map of the North/South areas is on page 59 of this booklet
- North area school are listed on pages 19-31

Name of School Headteacher Postal Address Telephone Number E-Mail Address Website DfE Number	School Type* See pages 56-57 for definitions)	Age Range	Published Admission Number 2018/19	Number of Applications received before the deadline for 2017	Number of Places Offered at allocation date September 2017	How places were allocated for September 2017 as at allocation date (See oversubscripti on criteria)	Criteria & distance (in metres) of the last place allocated for September 2017 (for oversubscribed schools)
Aldingbourne Primary Miss E Webster Westergate Street Westergate Chichester PO20 3QR (01243) 542913 office@aldingbourne.w-sussex.sch.uk www.aldingbourneprimarieschool.co.uk 2000	Community	4-11	30	51	30	Children with a Statement: 0 Criteria 1: 1 Criteria 2: 0 Criteria 3: 8 Criteria 4: 21 Criteria 5: 0 Criteria 6: 0	Criteria 4 872.03 m
Amberley CE Primary (Controlled) Mr J Gilbert School Road Amberley BN18 9NB (01798) 831612 office@amberley.w-sussex.sch.uk www.amberley.w-sussex.sch.uk 3000	Voluntary Controlled	4-11	10 (12 STC)	6	6	All on time applicants who requested this school were offered a place.	
Angmering St Margaret's CE Primary Mr M Jee Arundel Road Angmering BN16 4LP (01903) 785416 office@st-margarets-pri.w-sussex.sch.uk www.stmargaretsprimary.org.uk 3300	Voluntary Aided	4-11	70	48	49	All on time applicants who requested this school were offered a place as well as children who applied after the deadline.	
Angmering St Wilfrid's Catholic Primary Mrs S Reynolds Arundel Road Angmering BN16 4JR (01903) 782188 office@st-wilfrids-angmering.w-sussex.sch.uk www.stwilfridsangmering.co.uk 3327	Voluntary Aided	4-11	30	16	16	All on time applicants who requested this school were offered a place.	
Arundel CE Primary Mr A Simpson Jarvis Road Arundel BN18 9HT (01903) 883149 office@arundel.w-sussex.sch.uk www.arundelchurchofenglandschool.org.uk 3301	Voluntary Aided	4-11	30	33	30	Children with a Statement: 0 Criteria 1: 0 Criteria 2: 1 Criteria 3: 11 Criteria 4: 5 Criteria 5: 1 Criteria 6: 3 Criteria 7: 0 Criteria 8: 9	Criteria 8 4720.96 m
Arundel St Philip's Catholic Primary Mrs L Horne London Road Arundel BN18 9BA (01903) 882115 office@st-philips.w-sussex.sch.uk www.stphilipsarundel.org.uk 3328	Voluntary Aided	4-11	30	23	25	All on time applicants who requested this school were offered a place as well as children who applied after the deadline.	

Name of School Headteacher Postal Address Telephone Number E-Mail Address Website DfE Number	School Type* (See pages 56-57 for definitions)	Age Range	Published Admission Number 2018/19	Number of Applications received before the deadline for 2017	Number of Places Offered at allocation date September 2017	How places were allocated for September 2017 as at allocation date (See oversubscripti on criteria)	Criteria & distance (in metres) of the last place allocated for September 2017 (for oversubscribed schools)
Ashington CE Primary (Controlled) Mrs P Fairweather Foster Lane Ashington Pulborough RH20 3PG (01903) 892365 office@ashington.w-sussex.sch.uk www.ashington.w-sussex.sch.uk 3001	Voluntary Controlled	4-11	30	41	30	Children with a Statement: 0 Criteria 1: 0 Criteria 2: 0 Criteria 3: 14 Criteria 4: 16 Criteria 5: 0 Criteria 6: 0	Criteria 4 536.60 m.
Ashurst CE Primary Mrs J Williams School Lane Ashurst Steyning BN44 3AY (01403) 710426 office@ashurstcofe-pri.w-sussex.sch.uk www.ashurstcofe-pri.w-sussex.sch.uk 3302	Voluntary Aided	4-11	8	14	9	Children with a Statement: 0 Criteria 1: 1 Criteria 2: 0 Criteria 3: 2 Criteria 4: 0 Criteria 5: 0 Criteria 6: 2 Criteria 7: 0 Criteria 8: 4	Criteria 8 4334.78 m
Barnham Primary Mr J Everett Elm Grove Barnham PO22 0HW (01243) 552197 office@barnhamprimaryschool.co.uk www.barnhamprimaryschool.co.uk 2138	Academy	4-11	45	63	45	Children with a Statement: 1 Criteria 1: 0 Criteria 2: 0 Criteria 3: 13 Criteria 4: 9 Criteria 5: 22 Criteria 6: 0	Criteria 5 1217.6 m
Birdham CE Primary (Controlled) Mr M McCadden Crooked Lane Birdham Chichester PO20 7HB (01243) 512399 office@birdhamprimary.co.uk www.birdhamprimary.co.uk 3002	Voluntary Controlled	4-11	21	17	18	All on time applicants who requested this school were offered a place as well as children who applied after the deadline.	
Bognor Regis Bartons Primary School Mrs K Powell Lethaby Road Bognor Regis PO21 5EJ (01243) 822056 office@bartonsprimary.school www.bartons.w-sussex.sch.uk 2186	Community	4-11	30	43	30	Children with a Statement: 1 Criteria 1: 0 Criteria 2: 0 Criteria 3: 9 Criteria 4: 14 Criteria 5: 6 Criteria 6: 0	Criteria 5 3555.16 m
Bognor Regis Bersted Green Primary Dr K Jarvis Laburnum Grove Bognor Regis PO22 9HT (01243) 822885 office@berstedgreen.school www.berstedgreenprimary.co.uk 2101	Community	4-11	60	41	60	All on time applicants who requested this school were offered a place as well as children who applied after the deadline.	
Bognor Regis Edward Bryant Primary Mrs C Williams (Executive Headteacher) Mr R Waddington (Operational Headteacher) London Road Bognor Regis PO21 1BG (01243) 822454 pmorris@edwardbryant.academy www.edwardbryantschool.co.uk 2007	Academy	4-11	90	96	90	Children with a Statement: 1 Criteria 1: 0 Criteria 2: 11 Criteria 3: 11 Criteria 4: 1 Criteria 5: 43 Criteria 6: 23	Criteria 6 1615.33 m
Bognor Regis Nyewood CE Infant Mrs J Cobb Brent Road Bognor Regis PO21 5NW (01243) 823283 office@nyewood-inf.w-sussex.sch.uk www.nyewood-inf.w-sussex.sch.uk 3348	Voluntary Aided	4-7	90	92	90	Children with a Statement: 0 Criteria 1: 0 Criteria 2: 0 Criteria 3: 18 Criteria 4: 0 Criteria 5: 29 Criteria 6: 4 Criteria 7: 39	Criteria 7 3950.64 m

Name of School Headteacher Postal Address Telephone Number E-Mail Address Website DfE Number	School Type* (See pages 56-57 for definitions)	Age Range	Published Admission Number 2018/19	Number of Applications received before the deadline for 2017	Number of Places Offered at allocation date September 2017	How places were allocated for September 2017 as at allocation date (See oversubscripti on criteria)	Criteria & distance (in metres) of the last place allocated for September 2017 (for oversubscribed schools)
Bognor Regis Rose Green Infant Mrs J Holloway Hawkins Close Bognor Regis PO21 3LW (01243) 262318 office@rosegreen-inf.w-sussex.sch.uk www.rosegreen-inf.w-sussex.sch.uk 2199	Community	4-7	90	108	90	Children with a Statement: 0 Criteria 1: 1 Criteria 2: 0 Criteria 3: 26 Criteria 4: 14 Criteria 5: 49 Criteria 6: 0 Criteria 7: 0	Criteria 5 832.01 m
Bognor Regis South Bersted CE Primary (Controlled) Mr C Kronda Church Lane Bognor Regis PO22 9PZ (01243) 821678 office@southbersted.co.uk www.southbersted.co.uk 3003	Voluntary Controlled	4-11	30	34	30	Children with a Statement: 0 Criteria 1: 0 Criteria 2: 0 Criteria 3: 4 Criteria 4: 10 Criteria 5: 5 Criteria 6: 11	Criteria 6 1108.17 m
Bognor Regis Southway Primary Miss S Holland Southway Bognor Regis PO21 5EZ (01243) 810200 office@southwayprimary.co.uk www.southwayprimary.co.uk 2016	Academy	3-11	90	97	90	Children with a Statement: 1 Criteria 1: 1 Criteria 2: 26 Criteria 3: 37 Criteria 4: 10 Criteria 5: 15 Criteria 6: 0	Criteria 5 1534.08 m
Bognor Regis St Mary's Catholic Primary Mr P Edgington Glamis Street Bognor Regis PO21 1DJ (01243) 822287 office@st-marys-bognor.w-sussex.sch.uk www.st-marys-bognor.co.uk 3329	Voluntary Aided	4-11	45	54	45	Children with a Statement: 0 Criteria 1: 1 Criteria 2: 9 Criteria 3: 17 Criteria 4: 0 Criteria 5: 0 Criteria 6: 4 Criteria 7: 0 Criteria 8: 0 Criteria 9: 0 Criteria 10: 14	Criteria 10 1010.51 m
Bosham Primary Mrs D Allen Walton Lane Bosham Chichester PO18 8QF (01243) 572375 office@boshamprimary.co.uk www.boshamprimary.co.uk 2009	Community	4-11	30	27	27	All on time applicants who requested this school were offered a place.	
Boxgrove CE Primary (Controlled) Mrs K Thornton The Street Boxgrove Chichester PO18 0EE (01243) 773309 office@boxgrove.w-sussex.sch.uk www.boxgrove.w-sussex.sch.uk 3004	Voluntary Controlled	4-11	10	16	10	Children with a Statement: 0 Criteria 1: 0 Criteria 2: 0 Criteria 3: 1 Criteria 4: 6 Criteria 5: 1 Criteria 6: 2	Criteria 6 1007.91 m
Bury CE (Aided) Primary Mr T Moore Westburton Lane Bury Pulborough RH20 1HB (01798) 831502 office@bury.school www.bury.w-sussex.sch.uk 3304	Voluntary Aided	4-11	10	0	0	No offers made for 2017 intake at allocation date	
Camelsdale Primary Mrs S Palmer School Road Haslemere Surrey GU27 3RN (01428) 642177 office@camelsdale.w-sussex.sch.uk www.camelsdale.w-sussex.sch.uk 2011	Community	4-11	30	54	30	Children with a Statement: 0 Criteria 1: 1 Criteria 2: 0 Criteria 3: 15 Criteria 4: 13 Criteria 5: 1 Criteria 6: 0	Criteria 5 653.46 m

Name of School Headteacher Postal Address Telephone Number E-Mail Address Website DfE Number	School Type* (See pages 56-57 for definitions)	Age Range	Published Admission Number 2018/19	Number of Applications received before the deadline for 2017	Number of Places Offered at allocation date September 2017	How places were allocated for September 2017 as at allocation date (See oversubscripti on criteria)	Criteria & distance (in metres) of the last place allocated for September 2017 (for oversubscribed schools)
Chichester Free School Mr G Martyn The Courtyard Vinnetrow Business Park Vinnetrow Road Runciton Chichester PO20 1QH (01243) 792690 admissions@chichesterfreeschool.org.uk www.chichesterfreeschool.org.uk 4006 <i>Site change pending – please refer to the school's website for information.</i>	Academy	4-18	60	102	60	Children with a Statement: 0 Criteria 1: 1 Criteria 2: 0 Criteria 3: 0 Criteria 4: 30 Criteria 5: 3 Criteria 6: 26	Not applicable as places allocated in final category by random allocation
Chichester Jessie Younghusband Primary Mrs A Sadler Woodlands Lane Chichester PO19 5PA (01243) 782192 office@jys.org.uk www.jys.org.uk 2112	Community	4-11	30	54	30	Children with a Statement: 0 Criteria 1: 1 Criteria 2: 0 Criteria 3: 12 Criteria 4: 16 Criteria 5: 1 Criteria 6: 0	Criteria 5 398.33 m
Chichester Kingsham Primary Mrs H Faulkner Hay Road Chichester PO19 8BN (01243) 784046 office@kingshamprimary.org.uk www.kingshamprimary.org.uk 2023	Academy	4-11	45	37	44	All on time applicants who requested this school were offered a place as well as children who applied after the deadline and those whose preferences for other schools couldn't be offered where this was either their catchment school or the nearest school with a place available.	
Chichester Lancastrian Infant Mrs Z Gordon Orchard Gardens Chichester PO19 1DG (01243) 782818 office@lancastrian.w-sussex.sch.uk www.lancastrian.w-sussex.sch.uk 2012	Community	4-7	45	18	20	All on time applicants who requested this school were offered a place as well as children who applied after the deadline and those whose preferences for other schools couldn't be offered where this was either their catchment school or the nearest school with a place available.	
Chichester Parklands Community Primary Miss A Henham Durnford Close Chichester PO19 3AG (01243) 788630 office@parklands.w-sussex.sch.uk www.parklands.w-sussex.sch.uk 2185	Community	4-11	60	73	60	Children with a Statement: 2 Criteria 1: 0 Criteria 2: 0 Criteria 3: 8 Criteria 4: 21 Criteria 5: 11 Criteria 6: 18	Criteria 6 1906.05 m
Chichester Portfield Primary Academy Mr J Munt (Executive Headteacher) Mr A Strong (Headteacher) St James' Road Chichester PO19 7HA (01243) 783939 office@portfield-tkat.org www.portfield-tkat.org 2006	Academy	4-11	30	25	28	All on time applicants who requested this school were offered a place as well as children who applied after the deadline and those whose preferences for other schools couldn't be offered where this was either their catchment school or the nearest school with a place available.	
Chichester Rumboldwhyke CE Infants' (Controlled) Mrs F Sayce Rumbolds Close Chichester PO19 7UA (01243) 782368 office@rumboldwhyke.w-sussex.sch.uk www.rumboldwhyke.w-sussex.sch.uk 3005	Voluntary Controlled	4-7	40	37	37	All on time applicants who requested this school were offered a place.	

Name of School Headteacher Postal Address Telephone Number E-Mail Address Website DfE Number	School Type* (See pages 56-57 for definitions)	Age Range	Published Admission Number 2018/19	Number of Applications received before the deadline for 2017	Number of Places Offered at allocation date September 2017	How places were allocated for September 2017 as at allocation date (See oversubscripti on criteria)	Criteria & distance (in metres) of the last place allocated for September 2017 (for oversubscribed schools)
Chichester St Richard's Catholic Primary Mrs Hunn Cawley Road Chichester PO19 1XB (01243) 784549 office@st-richardsschool-chichester.org.uk www.st-richards.w-sussex.sch.uk 3330	Voluntary Aided	4-11	45	60	45	Children with a Statement: 0 Criteria 1: 0 Criteria 2: 21 Criteria 3: 13 Criteria 4: 1 Criteria 5: 0 Criteria 6: 6 Criteria 7: 1 Criteria 8: 2 Criteria 9: 1 Criteria 10: 0	Criteria 9 530.94 m
Chidham Parochial Primary (Controlled) Miss C Murphy Chidham Lane Chidham PO18 8TH (01234) 572380 office@chidham.w-sussex.sch.uk chidhamschool.org.uk 3006	Voluntary Controlled	4-11	30	26	29	All on time applicants who requested this school were offered a place as well as children who applied after the deadline	
Clapham and Patching CE Primary (Controlled) Miss J Jones The Street Clapham Worthing BN13 3UU (01903) 871214 office@claphamandpatching.co.uk www.claphamandpatching.co.uk 3007	Voluntary Controlled	4-11	8	9	8	Children with a Statement: 0 Criteria 1: 0 Criteria 2: 0 Criteria 3: 0 Criteria 4: 1 Criteria 5: 5 Criteria 6: 2	Criteria 6 2575.30 m
Clymping St Mary's CE Primary Mrs J Llewellyn Brookpit Lane Clymping Littlehampton BN17 5QU (01903) 714325 office@st-marysclymping.w-sussex.sch.uk www.stmarysclymping.org.uk 3308	Voluntary Aided	4-11	15	24	15	Children with a Statement: 0 Criteria 1: 6 Criteria 2: 8 Criteria 3: 0 Criteria 4: 1 Criteria 5: 0 Criteria 6: 0 Criteria 7: 0	Criteria 4 4302.50 m
Coldwaltham St James' CE Primary (Controlled) Mr J Gilbert Church Lane Coldwaltham Pulborough RH20 1LW (01798) 872196 office@st-james-coldwaltham.w-sussex.sch.uk www.st-james.coldwaltham.w-sussex.sch.uk 3009	Voluntary Controlled	4-11	15	6	6	All on time applicants who requested this school were offered a place.	
Compton and Up Marden CE Primary (Controlled) Mrs C Inskip School Lane Compton Chichester PO18 9EZ (023 92) 631900 office@cuprimary.co.uk www.comptonupmarden.w-sussex.sch.uk 3010	Voluntary Controlled	4-11	20	14	14	All on time applicants who requested this school were offered a place.	
Easebourne CE Primary (Controlled) Mr J Culley Wheelbarrow Castle Easebourne Midhurst GU29 9AG (01730) 813266 office@easebourne.w-sussex.sch.uk www.easebourne.w-sussex.sch.uk 3043	Voluntary Controlled	4-11	30	50	45	Children with a Statement: 1 Criteria 1: 0 Criteria 2: 0 Criteria 3: 7 Criteria 4: 4 Criteria 5: 10 Criteria 6: 23	Category 6 3328.48 m
Eastergate CE Primary (Controlled) Ms C Ward Church Lane Eastergate Chichester PO20 3UT (01243) 542297 office@eastergate.w-sussex.sch.uk www.eastergate.w-sussex.sch.uk 3014	Voluntary Controlled	4-11	30	27	30	All on time applicants who requested this school were offered a place as well as children whose preferences for other schools couldn't be offered where this was either their catchment school or the nearest school with a place available.	

Name of School Headteacher Postal Address Telephone Number E-Mail Address Website DfE Number	School Type* (See pages 56-57 for definitions)	Age Range	Published Admission Number 2018/19	Number of Applications received before the deadline for 2017	Number of Places Offered at allocation date September 2017	How places were allocated for September 2017 as at allocation date (See oversubscription criteria)	Criteria & distance (in metres) of the last place allocated for September 2017 (for oversubscribed schools)
East Preston Infants Mrs C New Lashmar Road East Preston BN16 1EZ (01903) 773177 office@epinf.co.uk www.epinf.co.uk 2183	Community	4-7	90	64	66	All on time applicants who requested this school were offered a place as well as children who applied after the deadline.	
East Wittering Community Primary Mrs S Parker Stocks Lane Chichester PO20 8NH (01243) 672208 / 672107 office@eastwittering.w-sussex.sch.uk www.eastwittering.w-sussex.sch.uk 2025	Community	4-11	45	34	36	All on time applicants who requested this school were offered a place as well as children who applied after the deadline.	
Felpham Bishop Tufnell CE Infant Mr S Moreton (Executive Headteacher) Pennyfields Felpham Bognor Regis PO22 6BN (01243) 584412 infantoffice@tufnell.org www.bishoptufnell-inf.w-sussex.sch.uk 3344	Voluntary Aided	4-7	90	67	77	All on time applicants who requested this school were offered a place as well as children who applied after the deadline.	
Felpham Downview Primary Mrs M Williams Wroxham Way Felpham Bognor Regis PO22 8ER (01243) 820511 office@downview.w-sussex.sch.uk www.downviewprimary.co.uk 2188	Academy	4-11	90	99	90	Children with a Statement: 1 Criteria 1: 0 Criteria 2: 0 Criteria 3: 0 Criteria 4: 37 Criteria 5: 43 Criteria 6: 1 Criteria 7: 8	Criteria 7 4158.1845
Fernhurst Primary Ms G Richardson Haslemere Road Fernhurst Haslemere GU27 3EA (01428) 653144 admissions@fernhurst.w-sussex.sch.uk www.fernhurst.w-sussex.sch.uk 2108	Academy	4-11	30	21	22	All on time applicants who requested this school were offered a place as well as children who couldn't be offered a place where this was either their catchment school or the nearest school with a place available.	
Ferring CE Primary (Controlled) Mrs G Silk Sea Lane Ferring Worthing BN12 5DU (01903) 243945 office@ferring.w-sussex.sch.uk www.ferringceschool.co.uk 3016	Voluntary Controlled	4-11	30	28	28	All on time applicants who requested this school were offered a place.	
Findon St John the Baptist CE Primary Mr R Yelland School Hill Findon Worthing BN14 0TR (01903) 873072 office@st-john-baptist.w-sussex.sch.uk www.st-john-baptist.w-sussex.sch.uk 3313	Voluntary Aided	4-11	20	21	21	All on time applicants who requested this school were offered a place.	
Fishbourne CE Primary (Controlled) Mrs N Day Roman Way Fishbourne Chichester PO19 3QS (01243) 785974 office@fishbourneprimary.co.uk www.fishbourneprimary.co.uk 3017	Voluntary Controlled	4-11	30	38	30	Children with a Statement: 2 Criteria 1: 0 Criteria 2: 0 Criteria 3: 6 Criteria 4: 20 Criteria 5: 2 Criteria 6: 0	Criteria 5 3010.19 m
Fittleworth CE Village School Mr G Bloomfield School Lane Fittleworth Pulborough RH20 1JB (01798) 865419 head@fittleworth.w-sussex.sch.uk www.fittleworthschool.org.uk 3018	Voluntary Controlled	4-11	15	26	22	Children with a Statement: 0 Criteria 1: 0 Criteria 2: 0 Criteria 3: 5 Criteria 4: 2 Criteria 5: 7 Criteria 6: 8	Criteria 6 8451.42 m

Name of School Headteacher Postal Address Telephone Number E-Mail Address Website DfE Number	School Type* (See pages 56-57 for definitions)	Age Range	Published Admission Number 2018/19	Number of Applications received before the deadline for 2017	Number of Places Offered at allocation date September 2017	How places were allocated for September 2017 as at allocation date (See oversubscripti on criteria)	Criteria & distance (in metres) of the last place allocated for September 2017 (for oversubscribed schools)
Funtington Primary Mrs S Tittley Heather Close West Ashling PO18 8DR (01243) 575675 office@funtingtonprimaryschool.co.uk www.funtington.w-sussex.sch.uk 2028	Community	4-11	20	13	13	All on time applicants who requested this school were offered a place.	
Graffham Infant School Mrs H Martin Graffham Petworth GU28 0NJ (01798) 867324 office@graffhaminfant.org.uk graffhamandduncton.w-sussex.sch.uk 2029	Community	4-7	20	23	20	Children with a Statement: 0 Criteria 1: 0 Criteria 2: 0 Criteria 3: 1 Criteria 4: 3 Criteria 5: 4 Criteria 6: 12	Criteria 6 7618.98 m
Harting CE Primary Mrs F Mullett Tipper Lane South Harting Petersfield Hants GU31 5QT (01730) 825388 office@harting.w-sussex.sch.uk www.harting.w-sussex.sch.uk 3063	Voluntary Controlled	4-11	20	27	20	Children with a Statement: 0 Criteria 1: 1 Criteria 2: 0 Criteria 3: 3 Criteria 4: 10 Criteria 5: 6 Criteria 6: 0	Criteria 5 11793.98 m
Henfield St Peter's CE Primary School Mr S McCulley Fabians Way Henfield BN5 9PU (01273) 492447 office@stpetershenfield.org.uk www.stpetershenfield.org.uk 3314	Voluntary Aided	4-11	60	52	53	All on time applicants who requested this school were offered a place as well as children who applied after the deadline	
Hollycombe Primary Ms L Pearce Wardley Green Milland Liphook Hants GU30 7LY (01428) 741332 office@hollycombe.w-sussex.sch.uk www.hollycombe.w-sussex.sch.uk 2030	Community	4-11	15	20	15	Children with a Statement: 0 Criteria 1: 0 Criteria 2: 0 Criteria 3: 5 Criteria 4: 1 Criteria 5: 4 Criteria 6: 5	Criteria 6 3937.09 m
Jolesfield CE Primary (Controlled) Mrs S Uff Littleworth Lane Partridge Green RH13 8JJ (01403) 710546 head@jolesfield.w-sussex.sch.uk www.jolesfield.w-sussex.sch.uk 3020	Voluntary Controlled	4-11	30	21	21	All on time applicants who requested this school were offered a place.	
Lancing The Globe Primary Mrs L Gould (Executive Headteacher) Mr R Leigh (Head of School) Irene Avenue Lancing BN15 9NZ (01903) 854970 office@theglobeprimary.co.uk www.theglobeprimary.co.uk 2026	Academy	4-11	90	50	52	All on time applicants who requested this school were offered a place as well as children who applied after the deadline and those whose preferences for other schools couldn't be offered where this was either their catchment school or the nearest school with a place available.	
Lancing North Lancing Primary Mrs E Brown Mill Road North Lancing BN15 0PT (01903) 752301 office@northlancing.w-sussex.sch.uk www.northlancing.w-sussex.sch.uk 2042	Community	4-11	60	58	60	All on time applicants who requested this school were offered a place as well as children who applied after the deadline.	
Lancing Seaside Primary Mr L Murley Freshbrook Road Lancing BN15 8DL (01903) 876300 office@seaside.w-sussex.sch.uk www.seaside.w-sussex.sch.uk 3367	Academy	4-11	90	99	90	Children with a Statement: 0 Criteria 1: 2 Criteria 2: 1 Criteria 3: 21 Criteria 4: 51 Criteria 5: 8 Criteria 6: 7	Criteria 6 940.81 m

Name of School Headteacher Postal Address Telephone Number E-Mail Address Website DfE Number	School Type* (See pages 56-57 for definitions)	Age Range	Published Admission Number 2018/19	Number of Applications received before the deadline for 2017	Number of Places Offered at allocation date September 2017	How places were allocated for September 2017 as at allocation date (See oversubscripti on criteria)	Criteria & distance (in metres) of the last place allocated for September 2017 (for oversubscribed schools)
Lavant CE Primary (Controlled) Mr A King West Stoke Road Lavant Chichester PO18 0BW (01243) 527382 office@lavant.w-sussex.sch.uk www.lavant.w-sussex.sch.uk 3021	Voluntary Controlled	4-11	15	21	15	Children with a Statement: 0 Criteria 1: 0 Criteria 2: 0 Criteria 3: 4 Criteria 4: 6 Criteria 5: 3 Criteria 6: 2	Criteria 6 1995.19 m
Littlehampton Lyminster Primary Mr S McGinley Wick Street Littlehampton BN17 7JZ (01903) 713642 office@lyminster.w-sussex.sch.uk www.lyminster.w-sussex.sch.uk 2198	Community	4-11	30	41	30	Children with a Statement: 1 Criteria 1: 0 Criteria 2: 0 Criteria 3: 13 Criteria 4: 16 Criteria 5: 0 Criteria 6: 0	Criteria 4 861.04 m
Littlehampton River Beach Primary Mr D Ayers York Road Littlehampton BN17 6EW (01903) 725500 office@riverbeach.w-sussex.sch.uk www.riverbeach.w-sussex.sch.uk 3374	Academy	3-11	90	104	90	Children with a Statement: 3 Criteria 1: 1 Criteria 2: 0 Criteria 3: 25 Criteria 4: 36 Criteria 5: 20 Criteria 6: 5	Criteria 6 359.20 m
Littlehampton St Catherine's Catholic Primary Mrs G Askham Highdown Drive Littlehampton BN17 6HL (01903) 716039 office@st-catherines.w-sussex.sch.uk www.st-catherines.w-sussex.sch.uk 3332	Voluntary Aided	4-11	30	33	30	Children with a Statement: 0 Criteria 1a: 0 Criteria 1b: 0 Criteria 2a: 7 Criteria 2b: 6 Criteria 3a: 0 Criteria 3b: 2 Criteria 4a: 0 Criteria 4b: 1 Criteria 5a: 2 Criteria 5b: 0 Criteria 6a: 0 Criteria 6b: 1 Criteria 7a: 6 Criteria 7b: 5	Criteria 7b 1196.70 m
Littlehampton White Meadows Primary Mrs Y Kidd Whitelea Road Littlehampton BN17 7JL (01903) 731774 office@whitemeadows.w-sussex.sch.uk www.whitemeadows.w-sussex.sch.uk 3375	Academy	4-11	90	85	90	All on time applicants who requested this school were offered a place as well as children who applied after the deadline and those whose preferences for other schools couldn't be offered where this was either their catchment school or the nearest school with a place available.	
Midhurst CE Primary (Controlled) Mrs S Clarke Ashfield Road Midhurst GU29 9JX (01730) 813526 office@midhurstprimary.co.uk www.midhurst-primary-school.co.uk 3023	Voluntary Controlled	4-11	30	55	30	Children with a Statement: 0 Criteria 1: 1 Criteria 2: 0 Criteria 3: 18 Criteria 4: 11 Criteria 5: 0 Criteria 6: 0	Criteria 4 437.68 m
Northchapel Community Primary Mrs H Coleman Pipers Lane Northchapel Petworth GU28 9JA (01428) 707352 office@northchapel.w-sussex.sch.uk www.northchapel.w-sussex.sch.uk 2048	Community	4-11	15	17	17	All on time applicants who requested this school were offered a place.	

Name of School Headteacher Postal Address Telephone Number E-Mail Address Website DfE Number	School Type* (See pages 56-57 for definitions)	Age Range	Published Admission Number 2018/19	Number of Applications received before the deadline for 2017	Number of Places Offered at allocation date September 2017	How places were allocated for September 2017 as at allocation date (See oversubscripti on criteria)	Criteria & distance (in metres) of the last place allocated for September 2017 (for oversubscribed schools)
North Mundham Primary Mrs J Carey School Lane North Mundham Chichester PO20 1LA (01243) 785502 office@northmundham.w-sussex.sch.uk www.northmundham.w-sussex.sch.uk 2049	Community	4-11	30	47	30	Children with a Statement: 0 Criteria 1: 0 Criteria 2: 0 Criteria 3: 11 Criteria 4: 16 Criteria 5: 3 Criteria 6: 0	Criteria 5 2170.88
Petworth CE Primary (Controlled) Mr J Galvin South Grove Petworth GU28 0EE (01798) 342369 office@petworth.w-sussex.sch.uk www.petworth.w-sussex.sch.uk 3026	Voluntary Controlled	4-11	30	19	19	All on time applicants who requested this school were offered a place.	
Rake CE Primary (Controlled) Mr D Bertwistle London Road Rake Liss Hants GU33 7JH (01730) 892126 office@rake.w-sussex.sch.uk www.rake.w-sussex.sch.uk 3024	Voluntary Controlled	4-11	15	23	17	Children with a Statement: 1 Criteria 1: 0 Criteria 2: 0 Criteria 3: 1 Criteria 4: 2 Criteria 5: 6 Criteria 6: 7	Criteria 6 4882.38 m
Rogate CE Primary (Controlled) Ms A O'Toole School Lane Rogate Petersfield Hants GU31 5HH (01730) 821329 office@rogate.w-sussex.sch.uk www.rogateprimaryschool.co.uk 3027	Voluntary Controlled	4-11	15	11	12	All on time applicants who requested this school were offered a place as well as children who applied after the deadline.	
Rustington Community Primary Mr N J White North Lane Rustington Littlehampton BN16 3PW (01903) 785271 office@rustington.academy rustington.w-sussex.sch.uk 2053	Academy	4-11	90	74	84	All on time applicants who requested this school were offered a place as well as children who applied after the deadline and those whose preferences for other schools couldn't be offered where this was either their catchment school or the nearest school with a place available.	
Rustington Georgian Gardens Community Primary Mrs V Stevens (Interim Head) Miss A Bowers (wef Jan 2018) Guildford Road Rustington BN16 3JJ (01903) 771555 office@georgiangardens.w-sussex.sch.uk www.georgiangardens.w-sussex.sch.uk 2237	Community	4-11	60	55	55	All on time applicants who requested this school were offered a place.	
Rustington Summerlea Community Primary Mrs H Morris Windsor Drive Rustington BN16 3SW (01903) 856783 office@summerleaschool.co.uk www.summerlea.w-sussex.sch.uk 2252	Community	4-11	60	82	60	Children with a Statement: 0 Criteria 1: 0 Criteria 2: 0 Criteria 3: 10 Criteria 4: 11 Criteria 5: 19 Criteria 6: 20	Criteria 6 1091.20 m
Selsey Medmerry Primary Mr M Tidd High Street Selsey Chichester PO20 0QJ (01243) 602738 office@medmerry.w-sussex.sch.uk www.medmerry.w-sussex.sch.uk 2194	Academy	4-11	30	24	24	All on time applicants who requested this school were offered a place.	
Selsey Seal Academy Mrs M Snodin East Street Selsey Chichester PO20 0BN (01243) 602746 office@seal-tkat.org www.seal-tkat.org 2005	Academy	4-11	60	53	57	All on time applicants who requested this school were offered a place as well as children who applied after the deadline.	

Name of School Headteacher Postal Address Telephone Number E-Mail Address Website DfE Number	School Type* (See pages 56-57 for definitions)	Age Range	Published Admission Number 2018/19	Number of Applications received before the deadline for 2017	Number of Places Offered at allocation date September 2017	How places were allocated for September 2017 as at allocation date (See oversubscripti on criteria)	Criteria & distance (in metres) of the last place allocated for September 2017 (for oversubscribed schools)
Shoreham Buckingham Park Primary Mrs L Swann Buckingham Road Shoreham-by-Sea BN43 5UD (01273) 453515 office@buckinghampark.co.uk www.buckinghamparkschool.co.uk 3370	Community	4-11	90	81	85	All on time applicants who requested this school were offered a place as well as children who applied after the deadline and those whose preferences for other schools couldn't be offered where this was either their catchment school or the nearest school with a place available.	
Shoreham/Southwick Eastbrook Primary Mrs J Sherlock Manor Hall Road Southwick BN42 4NF (01273) 874050 office@eastbrook.w-sussex.sch.uk www.eastbrook.w-sussex.sch.uk 2019	Academy	4-11	60	83	60	Children with a Statement: 1 Criteria 1: 1 Criteria 2: 0 Criteria 3: 15 Criteria 4: 32 Criteria 5: 7 Criteria 6: 4	Criteria 6 795.03 m
Shoreham/Southwick Glebe Primary Miss J Kelly Church Lane Southwick Brighton BN42 4GB (01273) 592163 office@glebeprimary.co.uk www.glebeprimary.co.uk 2172	Community	4-11	90	83	86	All on time applicants who requested this school were offered a place as well as children who applied after the deadline.	
Shoreham/Southwick Holmbush Primary Mrs R Jackson Hawkins Crescent Shoreham-by-Sea BN43 6TN (01273) 592471 office@holmbushprimaryacademy.org.uk www.holmbushprimaryacademy.org.uk 2166	Academy	4-11	30	40	30	Children with a Statement: 0 Criteria 1: 1 Criteria 2: 0 Criteria 3: 14 Criteria 4: 15 Criteria 5: 0 Criteria 6: 0	Criteria 4 1396.26 m
Shoreham Shoreham Beach Primary Miss R Woodman Shingle Road Shoreham-by-Sea BN43 5RH (01273) 462688 office@shorehambeachprimary.co.uk www.shorehambeach.w-sussex.sch.uk 2131	Community	4-11	30	38	30	Children with a Statement: 0 Criteria 1: 1 Criteria 2: 0 Criteria 3: 18 Criteria 4: 9 Criteria 5: 2 Criteria 6: 0 Criteria 7: 0	Criteria 5 650.66 m
Shoreham/Southwick St Nicolas and St Mary's CE Primary Mr A Lincoln (Acting Headteacher) Eastern Avenue Shoreham-by-Sea BN43 6PE (01273) 454470 office@stnm.org.uk www.stnicolasmary.w-sussex.sch.uk 3343	Voluntary Aided	3-11	60	72	60	Children with a Statement: 1 Criteria 1: 2 Criteria 2: 19 Criteria 3: 9 Criteria 4: 3 Criteria 5: 7 Criteria 6: 9 Criteria 7: 0 Criteria 8: 10	Criteria 8 884.47m
Shoreham St Peter's Catholic Primary Mrs K Crees Sullington Way Shoreham-by-Sea BN43 6PJ (01273) 454066 office@stpetersshoreham.co.uk www.stpeterscatholicprimary.com 3333	Voluntary Aided	4-11	30	39	30	Children with a Statement: 0 Criteria 1: 0 Criteria 2: 9 Criteria 3: 9 Criteria 4: 0 Criteria 5: 0 Criteria 6: 3 Criteria 7: 0 Criteria 8: 1 Criteria 9: 1 Criteria 10: 0 Criteria 11: 0 Criteria 12: 1 Criteria 13: 0 Criteria 14: 6 Criteria 15: 0	Criteria 14 2095.05m

Name of School Headteacher Postal Address Telephone Number E-Mail Address Website DfE Number	School Type* (See pages 56-57 for definitions)	Age Range	Published Admission Number 2018/19	Number of Applications received before the deadline for 2017	Number of Places Offered at allocation date September 2017	How places were allocated for September 2017 as at allocation date (See oversubscripti on criteria)	Criteria & distance (in metres) of the last place allocated for September 2017 (for oversubscribed schools)
Shoreham Swiss Gardens Primary Mr L Caughlin Swiss Gardens Shoreham-by-Sea BN43 5WH (01273) 453176 office@sgprimary.co.uk www.swissgardens.w-sussex.sch.uk 2173	Community	4-11	60	75	60	Children with a Statement: 1 Criteria 1: 0 Criteria 2: 0 Criteria 3: 24 Criteria 4: 32 Criteria 5: 3 Criteria 6: 0	Criteria 5 1652.77 m
Sidlesham Primary Mrs A Bardsley Keynor Lane Sidlesham Chichester PO20 7NL (01243) 641238 office@sidlesham.w-sussex.sch.uk www.sidleshamprimary.co.uk 2058	Community	4-11	20	28	20	Children with a Statement: 0 Criteria 1: 0 Criteria 2: 0 Criteria 3: 5 Criteria 4: 8 Criteria 5: 7 Criteria 6: 0	Criteria 5 6176.10m
Singleton CE Primary (Controlled) Mr C Todd Charlton Road Singleton Chichester PO18 0HP (01243) 811679 office@singleton.w-sussex.sch.uk www.singleton.w-sussex.sch.uk 3029	Voluntary Controlled	4-11	10	9	10	All on time applicants who requested this school were offered a place as well as children whose preferences for other schools couldn't be offered where this was either their catchment school or the nearest school with a place available.	
Slindon CE Primary School (Controlled) Miss L Cooper Meadway Slindon Arundel BN18 0QU (01243) 814330 office@slindon.w-sussex.sch.uk www.slindonprimaryschool.co.uk 3030	Voluntary Controlled	4-11	12	9	10	All on time applicants who requested this school were offered a place as well as children whose preferences for other schools couldn't be offered where this was either their catchment school or the nearest school with a place available	
Sompting Village Primary Mr R Cave White Styles Road Sompting Lancing BN15 0BU (01903) 204627 office@somptingvillageprimary.co.uk www.somptingvillageprimary.co.uk 3368	Community	4-11	90	77	81	All on time applicants who requested this school were offered a place as well as children who applied after the deadline.	
Southbourne Infant Mrs L Partridge New Road Southbourne Emsworth Hants PO10 8JX (01243) 372727 office@southbourneinfants.co.uk www.southbourneinfants.co.uk 2105	Community	4-7	60	56	59	All on time applicants who requested this school were offered a place.	
Stedham Primary Mrs S Dreckmann School Lane Stedham Midhurst GU29 0NY (01730) 813522 office@stedham.w-sussex.sch.uk www.stedham.w-sussex.sch.uk 2066	Community	4-11	15	17	18	All on time applicants who requested this school were offered a place as well as children who applied after the deadline.	
Steyning CE Primary (Controlled) Mrs S Harrison Shooting Field Steyning BN44 3RQ (01903) 813420 office@steyningprimary.w-sussex.sch.uk www.steyningprimary.org.uk 3033	Voluntary Controlled	4-11	60	53	55	All on time applicants who requested this school were offered a place as well as children who applied after the deadline.	
Storrington Primary Mrs M Smith Spierbridge Road Storrington RH20 4PG (01903) 742047 office@storringtonprimary.co.uk www.storringtonprimary.co.uk 2102	Community	4-11	60	53	54	All on time applicants who requested this school were offered a place as well as children who applied after the deadline.	

Name of School Headteacher Postal Address Telephone Number E-Mail Address Website DfE Number	School Type* (See pages 56-57 for definitions)	Age Range	Published Admission Number 2018/19	Number of Applications received before the deadline for 2017	Number of Places Offered at allocation date September 2017	How places were allocated for September 2017 as at allocation date (See oversubscripti on criteria)	Criteria & distance (in metres) of the last place allocated for September 2017 (for oversubscribed schools)
Tangmere Primary Academy Mr P Turney Bishops Road Tangmere Chichester PO20 2JB (01243) 773339 office@tangmere-tkat.org www.tangmere-tkat.org 2003	Academy	4-11	30	26	27	All on time applicants who requested this school were offered a place as well as children who applied after the deadline.	
Thakeham Primary Mrs S Norton Rock Road Storrington West Sussex RH20 3QU (01798) 812133 office@thakehamps.co.uk www.thakehamfs.co.uk 2069	Community	4-11	15	7	10	All on time applicants who requested this school were offered a place as well as children whose preferences for other schools couldn't be offered where this was either their catchment school or the nearest school with a place available.	
Following the Age of Transfer re-organisation in the STARs Area, Thakeham School will move to Rock Road Storrington – web/email and telephone numbers may be subject to amendment.							
Thorney Island Community Primary Mr D Clegg Thorney Island Emsworth Hants PO10 8DJ (01243) 371317 office@ticsps.co.uk www.thorneyisland.w-sussex.sch.uk 2093	Community	4-11	30	24	25	All on time applicants who requested this school were offered a place as well as children who applied after the deadline.	
Upper Beeding Primary Mrs R Linford School Road Upper Beeding Steyning BN44 3HY (01903) 812288 office@upperbeeding.w-sussex.sch.uk https://upper-beeding.eschools.co.uk/web 2070	Community	4-11	45	46	45	Children with a Statement: 0 Criteria 1: 0 Criteria 2: 0 Criteria 3: 15 Criteria 4: 17 Criteria 5: 7 Criteria 6: 6	Criteria 6 6015.97 m
Walberton & Binsted CE Primary (Controlled) Mrs L Brockhurst The Street Walberton Arundel BN18 0PH (01243) 551398 secretary@walbertonbinsted.org.uk www.walbertonandbinstedschool.co.uk 3036	Voluntary Controlled	4-11	30	39	30	Children with a Statement: 0 Criteria 1: 0 Criteria 2: 0 Criteria 3: 6 Criteria 4: 10 Criteria 5: 4 Criteria 6: 10	Criteria 6 3299.20m
Washington St Mary's CE Primary (Controlled) Mrs K Houston School Lane Washington RH20 4AP (01903) 892401 office@stmaryswashington.co.uk www.stmaryswashington.co.uk 3038	Voluntary Controlled	4-11	15	20	16	Children with a Statement: 0 Criteria 1: 0 Criteria 2: 0 Criteria 3: 2 Criteria 4: 8 Criteria 5: 3 Criteria 6: 3	Criteria 6 1663.43 m
Westbourne Primary Mr S Potter River Street Westbourne Emsworth PO10 8TG (01243) 372726 office@westbourneprimary.co.uk www.westbourneprimary.co.uk 2071	Community	4-11	30	35	30	Children with a Statement: 0 Criteria 1: 0 Criteria 2: 0 Criteria 3: 10 Criteria 4: 6 Criteria 5: 8 Criteria 6: 6	Criteria 6 938.32 m
West Chiltington Community Primary Mr J Rose East Street West Chiltington Pulborough RH20 2JY (01798) 813319 office@westchiltschool.com www.westchiltschool.com 2072	Community	4-11	30	41	30	Children with a Statement: 0 Criteria 1: 0 Criteria 2: 0 Criteria 3: 8 Criteria 4: 11 Criteria 5: 7 Criteria 6: 4	Criteria 6 2209.35 m

Name of School Headteacher Postal Address Telephone Number E-Mail Address Website DfE Number	School Type* (See pages 56-57 for definitions)	Age Range	Published Admission Number 2018/19	Number of Applications received before the deadline for 2017	Number of Places Offered at allocation date September 2017	How places were allocated for September 2017 as at allocation date (See oversubscripti on criteria)	Criteria & distance (in metres) of the last place allocated for September 2017 (for oversubscribed schools)
West Dean CE Primary (Controlled) Mrs G Moss A286 West Dean Chichester PO18 0RJ (01243) 811247 office@westdean.w-sussex.sch.uk http://west-dean.eschools.co.uk 3045	Voluntary Controlled	4-11	14	19	14	Children with a Statement: 0 Criteria 1: 0 Criteria 2: 0 Criteria 3: 1 Criteria 4: 2 Criteria 5: 5 Criteria 6: 6	Criteria 6 7204.59 m
Westhampnett The March CE Primary Mrs N Metcalfe Claypit Lane Westhampnett Chichester PO18 0NU (01243) 783987 office@march.w-sussex.sch.uk www.march.w-sussex.sch.uk 3321	Voluntary Aided	4-11	30	34	30	Children with a Statement: 0 Criteria 1: 0 Criteria 2: 15 Criteria 3: 0 Criteria 4: 5 Criteria 5: 3 Criteria 6: 7	Criteria 6 1870.78 m
West Wittering Parochial CE (Controlled) Mr R Weston (Acting Headteacher) Pound Road West Wittering PO20 8AJ (01243) 513015 office@westwittering.w-sussex.sch.uk www.westwitteringschool.co.uk 3039	Voluntary Controlled	4-11	15	13	14	All on time applicants who requested this school were offered a place as well as children who applied after the deadline.	
Worthing Bramber Primary Ms T Taylor Bramber Road Worthing BN14 8QB (01903) 219277 office@bramberprimary.com http://www.bramberprimary.com/website 2246	Community	4-11	30	42	30	Children with a Statement: 0 Criteria 1: 1 Criteria 2: 1 Criteria 3: 4 Criteria 4: 10 Criteria 5: 11 Criteria 6: 3	Criteria 6 804.64 m
Worthing Broadwater CE School Mr J Wong Rectory Gardens Worthing BN14 7TQ (01903) 235389 office@broadwaterce.org www.broadwater.w-sussex.sch.uk 3324	Voluntary Aided	4-11	60	74	60	Children with a Statement: 0 Criteria 1: 1 Criteria 2: 16 Criteria 3: 10 Criteria 4: 12 Criteria 5: 0 Criteria 6: 0 Criteria 7: 21 Criteria 8: 0 Criteria 9: 0	Criteria :7 1074.50m
Worthing Downsbrook Primary Mr J Grover Dominion Road Worthing BN14 8GD (01930) 230467 office@downsbrook.eu www.downsbrook.w-sussex.sch.uk 2140	Community	4-11	90	41	42	All on time applicants who requested this school were offered a place as well as children who applied after the deadline and those whose preferences for other schools couldn't be offered where this was either their catchment school or the nearest school with a place available.	
Worthing Durrington Infant Mrs S Ensor and Mrs Z Wilby (Co Headteachers) Salvington Road Worthing BN13 2JD (01903) 260138 officeinfant@dfed.co.uk www.durringtoninfantjunior.co.uk 2076	Community	3-7	90	55	68	All on time applicants who requested this school were offered a place as well as children who applied after the deadline and those whose preferences for other schools couldn't be offered where this was either their catchment school or the nearest school with a place available.	
Worthing Elm Grove Primary Mrs L Udell Elm Grove Worthing BN11 5LQ (01903) 249387 office@elmgrove.org.uk www.elmgrove.org.uk/wsussex/primary/elmgrove 2077	Community	4-11	30	84	30	Children with a Statement: 0 Criteria 1: 1 Criteria 2: 1 Criteria 3: 12 Criteria 4: 12 Criteria 5: 4 Criteria 6: 0	Criteria 5 469.66 m

Name of School Headteacher Postal Address Telephone Number E-Mail Address Website DfE Number	School Type* (See pages 56-57 for definitions)	Age Range	Published Admission Number 2018/19	Number of Applications received before the deadline for 2017	Number of Places Offered at allocation date September 2017	How places were allocated for September 2017 as at allocation date (See oversubscripti on criteria)	Criteria & distance (in metres) of the last place allocated for September 2017 (for oversubscribed schools)
Worthing English Martyrs Catholic Primary Dr H Townsley Derwent Drive Worthing BN12 6LA (01903) 502868 office@englishmartyrs.w-sussex.sch.uk englishmartyrs.w-sussex.sch.uk/wordpress 3345	Voluntary Aided	4-11	30	30	30	All on time applicants who requested this school were offered a place.	
Worthing Field Place Infant Mrs T Alford Nelson Road Worthing BN12 6EN (01903) 700234 office@fieldplace.org www.fieldplace.greenschoolsonline.co.uk 2080	Community	4-7	120	87	105	All on time applicants who requested this school were offered a place as well as children who applied after the deadline and those whose preferences for other schools couldn't be offered where this was either their catchment school or the nearest school with a place available.	
Worthing Goring-by-Sea CE Primary Mrs C Jee Mulberry Lane Goring-by-Sea BN12 4RN (01903) 241175 office@goring.w-sussex.sch.uk http://goring.schooljotter2.com 3339	Voluntary Aided	4-11	60	69	60	Children with a Statement: 0 Criteria 1: 1 Criteria 2: 6 Criteria 3: 4 Criteria 4: 21 Criteria 5: 3 Criteria 6: 12 Criteria 7: 13	Criteria 7 1729.42
Worthing Hawthorns Primary Ms K Offer Poplar Road Durrington Worthing BN13 3EZ (01903) 268174 office@hawthorns.w-sussex.sch.uk www.hawthornsprimaryschool.co.uk 2227	Community	4-11	30	43	30	Children with a Statement: 0 Criteria 1: 0 Criteria 2: 0 Criteria 3: 3 Criteria 4: 18 Criteria 5: 6 Criteria 6: 3	Criteria 6 667.80 m
Worthing Heene CE Primary Mrs J MacGovern Norfolk Street Worthing BN11 4BB (01903) 201386 admissions@heenepprimary.co.uk www.heenepprimary.co.uk 3326	Voluntary Aided	4-11	60	84	60	Children with a Statement: 1 Criteria 1: 0 Criteria 2: 0 Criteria 3: 2 Criteria 4: 1 Criteria 5: 56 Criteria 6: 0 Criteria 7: 0 Criteria 8: 0	Criteria 5 792.55 m
Worthing Laurels Primary Mrs L de Carteret Winterbourne Way Worthing BN13 3QH (01903) 830901 office@laurels.w-sussex.sch.uk www.laurels.w-sussex.sch.uk 2233	Academy	4-11	30	51	30	Children with a Statement: 2 Criteria 1: 0 Criteria 2: 0 Criteria 3: 0 Criteria 4: 10 Criteria 5: 18 Criteria 6: 0 Criteria 7: 0	Criteria 5 464.39 m
Worthing Lyndhurst Infant Mrs D South Lyndhurst Road Worthing BN11 2DG (01903) 235390 office@lyndhurst-school.co.uk www.lyndhurst-school.co.uk 2238	Community	4-7	120	101	107	All on time applicants who requested this school were offered a place as well as children who applied after the deadline and those whose preferences for other schools couldn't be offered where this was either their catchment school or the nearest school with a place available.	
Worthing Springfield Infant Mrs R Wycherley Sackville Road Worthing BN14 8BQ (01903) 219243 office@springfield.co.uk www.springfieldschool.co.uk 2245	Community	4-7	60	65	60	Children with a Statement: 0 Criteria 1: 0 Criteria 2: 0 Criteria 3: 9 Criteria 4: 25 Criteria 5: 5 Criteria 6: 21	Criteria 6 1224.36 m

Name of School Headteacher Postal Address Telephone Number E-Mail Address Website DfE Number	School Type* (See pages 56-57 for definitions)	Age Range	Published Admission Number 2018/19	Number of Applications received before the deadline for 2017	Number of Places Offered at allocation date September 2017	How places were allocated for September 2017 as at allocation date (See oversubscripti on criteria)	Criteria & distance (in metres) of the last place allocated for September 2017 (for oversubscribed schools)
Worthing St Mary's Catholic Primary Mr D Carter (Executive Head) Mrs L Hardy (Acting Head) Cobden Road Worthing BN11 4BD (01903) 234115 office@stmarysworthing.org.uk www.stmarysworthing.org.uk 2041	Academy	4-11	45	39	45	All on time applicants who requested this school were offered a place as well as children who applied after the deadline and those whose preferences for other schools couldn't be offered where this was either their catchment school or the nearest school with a place available.	
Worthing Thomas A Becket Infant Mrs A Dingwall Pelham Road Worthing BN13 1JB (01903) 235386 office@tabinfant.org.uk www.tabinfant.org.uk 2231	Community	4-7	180	219	180	Children with a Statement: 0 Criteria 1: 1 Criteria 2: 0 Criteria 3: 44 Criteria 4: 113 Criteria 5: 15 Criteria 6: 7	Criteria 6 543.75 m
Worthing Vale School Mr M Garratt Vale Avenue Worthing BN14 0DB (01903) 872322 office@valeschool.org www.vale.w-sussex.sch.uk 2082	Community	4-11	90	80	83	All on time applicants who requested this school were offered a place as well as children who applied after the deadline and those whose preferences for other schools couldn't be offered where this was either their catchment school or the nearest school with a place available.	
Worthing West Park CE Primary Mrs C Bull Marlborough Road Worthing BN12 4HD (01903) 243099 office@westparksch.uk www.westpark.w-sussex.sch.uk 3062	Voluntary Controlled	4-11	120	137	120	Children with a Statement: 2 Criteria 1: 1 Criteria 2: 0 Criteria 3: 16 Criteria 4: 42 Criteria 5: 21 Criteria 6: 38	Criteria 6 1554.91 m
Worthing Whytemead Primary Mr G Ward Dominion Road Worthing BN14 8LH (01903) 202639 office@whytemead.w-sussex.sch.uk www.whytemead.w-sussex.sch.uk 2075	Community	4-11	45	51	45	Children with a Statement: 0 Criteria 1: 1 Criteria 2: 1 Criteria 3: 12 Criteria 4: 17 Criteria 5: 8 Criteria 6: 6	Criteria 6 1168.33 m
Yapton CE Primary (Controlled) Mr N Sharp North End Road Yapton Arundel BN18 0DU (01243) 551246 office@yaptonschool.org www.yaptonschool.org 3040	Voluntary Controlled	4-11	45	40	42	All on time applicants who requested this school were offered a place as well as children who applied after the deadline and those whose preferences for other schools couldn't be offered where this was either their catchment school or the nearest school with a place available.	

St Clement CE Primary Academy

The opening date for a new Free School, St Clement CE Primary Academy Shoreham, has yet to be confirmed. For the first year of opening, parents may need to apply directly to the new school rather than via the local authority. For further information please visit www.stclement.academy or email stclement@stnm.org.uk

Linked Infant/Junior Schools in the Southern Area – for sibling link purposes

Bognor Regis, Rose Green Infant	Bognor Regis, Rose Green Junior
Graffham Infant	Duncton Junior
East Preston Infant	East Preston Junior

Southbourne Infant	Southbourne Junior
Worthing, Lyndhurst Infant	Worthing, Chesswood Junior
Worthing, Springfield Infant	Worthing, Chesswood Junior
Worthing, Durrington Infant	Worthing, Durrington Junior
Worthing, Field Place Infant	Worthing, Orchards Junior
Worthing, Thomas A Becket Infant	Worthing, Thomas A Becket Junior

Oversubscription Criteria for Schools in West Sussex for September 2018

(Oversubscription Criteria for previous years is available on the website.)

West Sussex County Council Oversubscription Criteria

These are the criteria that apply to the majority of community and voluntary controlled schools.

- The tie-break used is a straight line distance. (Where the tie-break produces two or more equal distances the deadlock is broken by random allocation.)
- All distances are measured by a straight line from the school to the child's home address, using Ordnance Survey data within the curtilage of the property.
- Where priority is given for a sibling, brothers or sisters may be half or step-siblings (by marriage or co-habitation) or foster siblings but must be living permanently at the same address.
- West Sussex County Council only gives sibling priority if the sibling will be at the school at the time of application and will still be in the school at the time of admission; or if the sibling will be attending the linked junior school in September 2018 (see pages 32 and 46 for the lists of linked schools). **Please note it is the parent's responsibility to tell the Pupil Admissions Team about sibling links in their application.**
- Children previously denied places requested by their parents at their catchment school are treated as living in the allocated school's catchment area (if it is a community or controlled school) for sibling purposes. **Please note that it is the parent's responsibility to indicate these circumstances in their application.**

Starting School Allocation:

Any child with an Education Health and Care Plan (or a statement of special educational needs) naming the school will automatically be admitted to that school, under section 324 of the Education Act 1996.

1. Looked after children (children in public care), children who were previously looked after who leave care under a special guardianship, residence, child arrangement or adoption order. See page 8 for further details. Evidence must be provided;
2. Children who need a place at the school on exceptional and compelling social, psychological or medical grounds. See page 9 for more information. Evidence must be provided;
3. Children who live in the catchment area with brothers or sisters already at the school or who will be attending the linked junior school in September 2018;
4. Other children who live in the catchment area;
5. Children who live outside the catchment area with brothers or sisters already at the school or who will be attending the linked junior school in September 2018;
6. Other children who live outside the catchment area.

Variations to West Sussex County Council's oversubscription criteria in the Northern Area

Maidenbower, Crawley

There are two infant schools in Maidenbower, **The Brook Infant School** and **Maidenbower Infant School**. Applications to the schools will be considered according to the oversubscription criteria as follows:

Any child with an Education Health and Care Plan (or a statement of special educational needs) naming the school will automatically be admitted to that school, under Section 324 of the Education Act 1996.

1. Looked after children, children who were previously looked after who leave care under a special guardianship, residence, child arrangement or adoption order. See page 8 for more information. Evidence must be provided;
2. Children who need a place at the school on exceptional and compelling social, psychological or medical grounds. See page 9 for more information. Evidence must be provided;
3. Children who live within the catchment area for the preferred school with brothers or sisters already at the school or who will be attending the linked junior school in September 2018;
4. Other children who live in the catchment area for the preferred school;
5. Other children who live in the catchment area for The Brook Infant School or Maidenbower Infant School with brothers or sisters already at the school or who will be attending the linked junior school in September 2018;
6. Other children who live in the catchment area for The Brook Infant School or Maidenbower Infant School;
7. Other children who live outside the catchment area for The Brook Infant School or Maidenbower Infant School with brothers or sisters already at the school or who will be attending the linked junior school in September 2018;
8. Other children who live outside the catchment area for The Brook Infant School or Maidenbower Infant School.

Southwater, Horsham

There are two schools with reception year intakes in Southwater: Castlewood Primary School and Southwater Infant Academy. Applications for Castlewood Primary School will be considered according to the oversubscription as follows:

Any child with an Education Health and Care Plan (or a statement of special educational needs) naming the school will automatically be admitted to that school, under Section 324 of the Education Act 1996.

1. Looked after children (children in public care), children who were previously looked after who leave care under a special guardianship, residence, child arrangement or adoption order. See page 8 for more information. Evidence must be provided;
2. Children who need a place at the school on exceptional and compelling social, psychological or medical grounds. See page 9 for more information. Evidence must be provided;
3. Children who live in the catchment area for Castlewood Primary School with brothers or sisters already attending the school and who will still be there when the child starts;
4. Other children who live in the catchment area for Castlewood Primary School;
5. Children who live within the catchment area for Southwater Infant Academy with brothers or sisters already attending the school and who will still be there when the child starts;
6. Other children who live within the catchment area for Southwater Infant Academy;
7. Children who live outside the catchment area for Castlewood Primary School and Southwater Infant Academy with brothers or sisters already at the school who will still be there when the child starts;
8. Other children who live outside the catchment area for Castlewood Primary School and Southwater Infant Academy.

Variations to West Sussex County Council's oversubscription criteria in the Southern Area Rose Green Infant School

Any child with an Education Health and Care Plan (or a statement of special educational needs) naming the school will automatically be admitted to that school, under Section 324 of the Education Act 1996.

1. Looked after children (children in public care), children who were previously looked after who leave care under a special guardianship, residence, child arrangement or adoption order. See page 8 for more information. Evidence must be provided;
2. Children who need a place at the school on exceptional and compelling social, psychological or medical grounds. See page 9 for more information. Evidence must be provided;
3. Children who live within the catchment area for the school with brothers or sisters already at the school or who will be attending the linked junior school in September 2018;
4. Other children who live in the catchment area for the school to the West of the line shown on the attached map;
5. Other children who live in the catchment area for the school to the East of the line shown on the attached map;
6. Other children who live outside the catchment area with brothers or sisters already at the school or who will be attending the linked junior school in September 2018;
7. Other children who live outside the catchment area. In the case of oversubscription in any category, priority is given to applicants who live nearest the school (measured by a straight line from school to the child's home address, using Ordnance Survey data within the curtilage of the property).

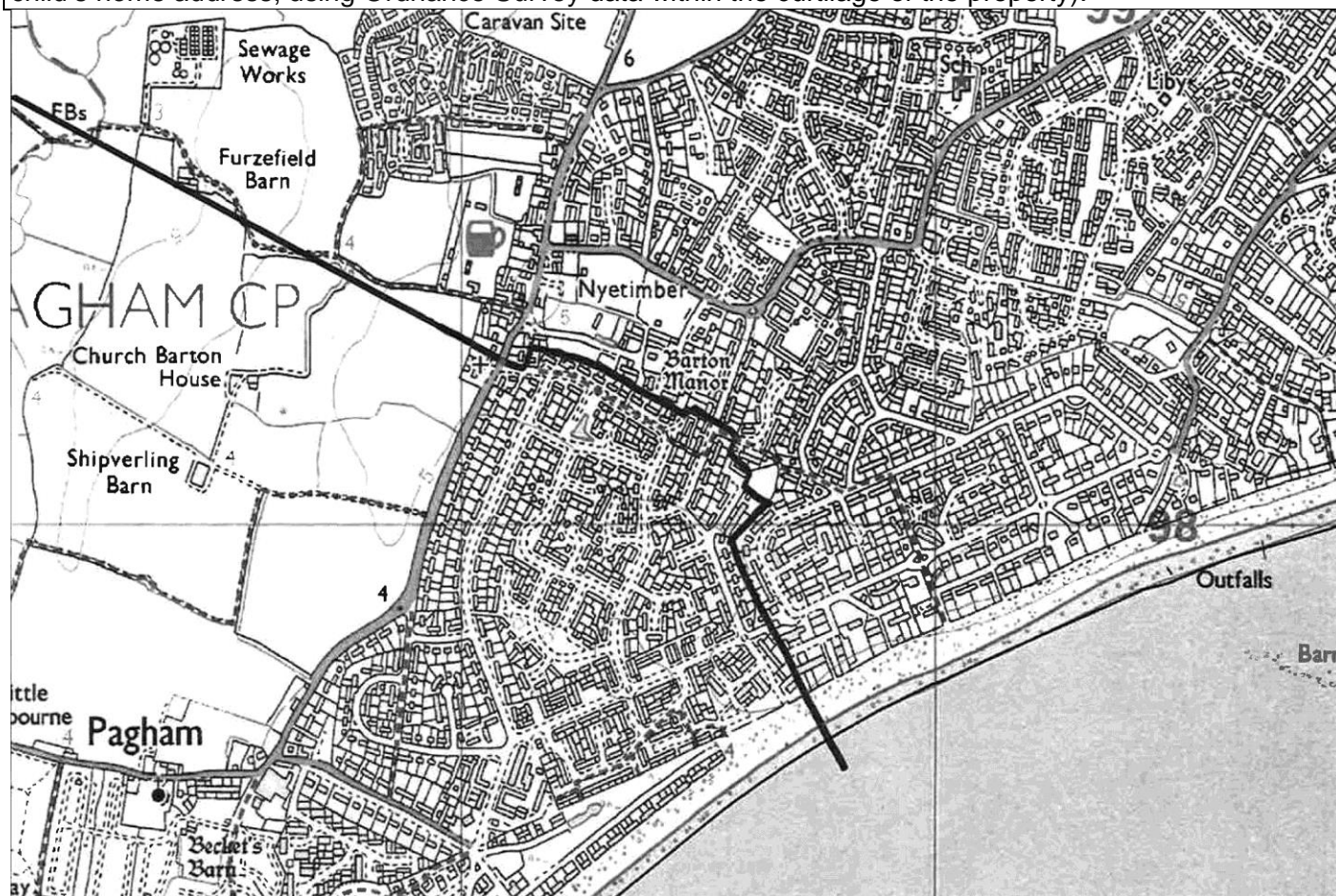

	<p>Reproduced from or based upon 2009 Ordnance Survey 1:2500 or 1:2500 mapping with permission of the Controller of HMSO © Crown Copyright reserved. Unauthorised reproduction infringes Crown copyright and may lead to prosecution or civil proceedings West Sussex County Council Licence No. 100033467</p> <p>Historical Data © Landmark Information Group</p> <p>Aerial photo copyrights - 2001 onwards: © GeoPerspectives</p>	<p>Rose Green Infants Variation 2013</p>	<p>May 21, 2012</p>	<p>1:10,478</p>	
--	---	---	---------------------	-----------------	---

Shoreham Beach Primary School

Any child with an Education Health and Care Plan (or a statement of special educational needs) naming the school will automatically be admitted to that school, under Section 324 of the Education Act 1996.

1. Looked after children (children in public care), children who were previously looked after who leave care under a special guardianship, residence, child arrangement or adoption order. See page 8 for more information. Evidence must be provided;
2. Children who need a place at the school on exceptional and compelling social, psychological or medical grounds. See page 9 for more information. Evidence must be provided;
3. Children who live within the catchment area for the school with brothers or sisters already at the school and who will still be there when the child starts;
4. Other children who live in the catchment area for the school to the East of Ferry Road;
5. Other children who live in the catchment area for the school to the West of, and including Ferry Road;
6. Other children who live outside the catchment area for Shoreham Beach Primary School with brothers or sisters already at the school and who will still be there when the child starts;
7. Other children who live outside the catchment area for Shoreham Beach Primary School.

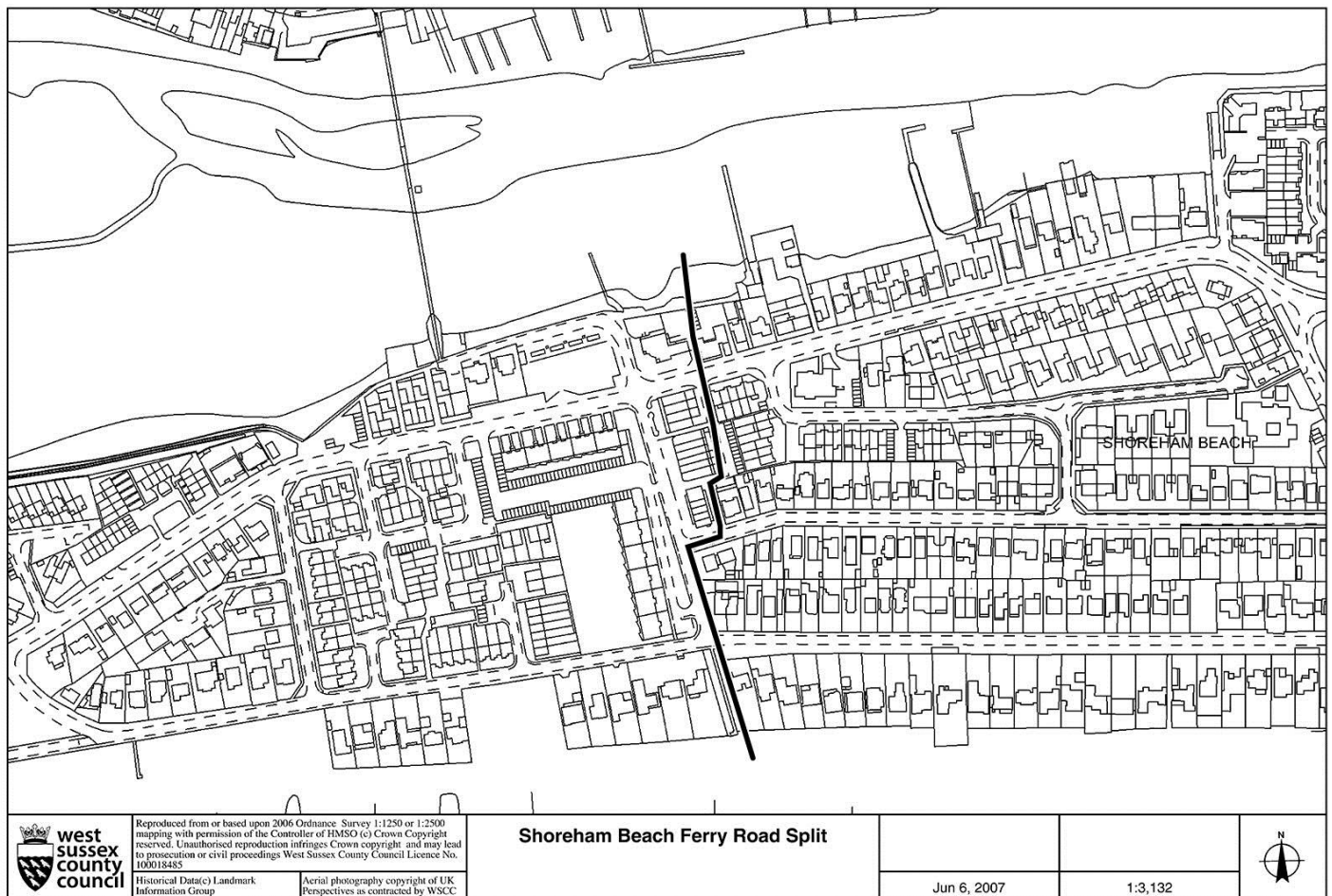

Church Voluntary Aided Schools, Foundation Schools, Free Schools and Academies

Church Voluntary Aided Schools, Foundation Schools, Free Schools and Academies are 'own admission authority schools', responsible for determining their own admission arrangements. Their oversubscription criteria are included in the school's published admission policy available on the school or admissions website.

Parents wishing to express a preference for any of these schools are advised to view the school's full admission policy and supporting notes, including definitions, available within the school's prospectus and on the school or admissions website.

Unless stated otherwise in the school's admission policy:

- The tie-break used is a straight line distance.
- All distances are measured by a straight line from the school to the child's home address, using Ordnance Survey data within the curtilage of the property.
- Brothers or sisters may be half or step-siblings (by marriage or co-habitation), or foster siblings but must be living permanently at the same address.
- Applications received after the application deadline will be considered after all the preferences received on time.
- Children with Statement of Special Educational Needs or EHCP naming a school will automatically be admitted under Section 324 of the Education Act 1996.
- Looked after children (children in public care), children who were previously looked after and are adopted, and children who leave care under a special guardianship, residence or child arrangement order are given priority. See page 8 for more information - evidence must be provided.

For full information on how places were allocated at these schools for September 2017 you should contact the school directly or consult their website. Information on the point where church aided and foundation schools and academies were oversubscribed is shown on pages 19-46.

TRANSPORT TO SCHOOL

WEST SUSSEX SUSTAINABLE MODES OF TRAVEL STRATEGY

Introduction

The Education and Inspections Act 2006 requires local authorities to publish a Sustainable Modes of Travel Strategy to promote the use of sustainable travel to and from school and between school establishments.

Aims of the Strategy

The Education and Inspections Act 2006 extends local authorities' duties to support choice through provision of transport and transport arrangements, including provision of free transport for the most disadvantaged families.

The strategy supports this by building on existing strategies, plans and policies adopted by the Local Authority. Through the implementation of the strategy the Local Authority will:

- Help to improve travel planning to schools and colleges

- Improve accessibility to schools and colleges
- Improve road safety and healthy lifestyles for children
- Continue to build on reduction of car use for school journeys
- Improve safety at school gates by discouraging illegal and inconsiderate parking behaviours at drop-off and pick-up times
- Increase walking, cycling and using public transport to and from school
- Encourage independent travel for children and students with special educational needs.

The Strategy

The strategy complements the West Sussex Transport Plan 2011-26 and draws from the Local Authority's other plans and strategies including:

- Safer Routes to School delivery programme
- School Travel Plan programme (including behavioural change activities)
- Road Safety Framework 2016-2026
- Walking and Cycling Strategy 2016-26
- Home to School and College transport policies which are summarised on pages 53-54 of this booklet.

School Travel Plans

Through the School Travel Plan Programme, the Local Authority is working alongside schools to ensure that all schools develop and maintain an accredited Travel Plan. Travel Plans are accredited through ModeShift Stars. School Travel Plans include advice for parents about existing travel to school and plans for improvement. They should measure and monitor the journey to and from school to help plan for future travel needs. School Travel Plans are available either through the schools' websites or by contacting schools direct. School websites and telephone numbers are listed on pages 19-46 of this booklet.

Walking to school

Through the development of walking buses, the Safer Routes to School programme and other walking initiatives (e.g. walk to school week), the Local Authority supports and encourages walking to school, not only to reduce car usage but to improve both the health of children and the environment locally.

Cycling

Through its Walking and Cycling Strategy 2016-26, the Local Authority is committed to promoting cycling as normal and acceptable behaviour including for travelling to and from school or college. As well as local information in some school travel plans, advice on cycling in West Sussex can be found on the County Council's website. The website also links to the West Sussex Cycle Journey Planner (see the table below for links.)

Schools will have their own cycling policies and will also be able to advise on the facilities that they can offer, such as cycle racks and storage.

Public Transport

The Local Authority is committed to promoting the use of public transport. Information about rail and bus timetables, fares and travel planning can be found through the links and contact points in the table below.

Students who attend full-time courses at sixth forms, sixth form colleges or colleges of further education can also get discounted rail season tickets using the Sussex Student Card, a scheme that is supported in partnership with Southern Railways.

The Local Authority works actively alongside bus operators to review existing and implement new bus infrastructure.

Help with Home to School and College transport

In the majority of cases, parents are responsible for their children's travel and costs. Some children and young people may be entitled to help with transport, depending on the school or college they attend and the distance between home and school. Individual circumstances may also be taken into account e.g. where a child or young person has special educational needs or where the family is on low income.

Further information about help with transport to and from school or college can be found on page 54 of this booklet or through the school transport website. Additional information for students attending sixth forms, sixth form colleges or colleges of further education can be found in the policy statement and its appendices published annually.

Independent Travel Training

The County Council is committed to the principles of inclusion and independent living for children and young people with special needs and disabilities. The ability to travel independently is an important part of preparing children and young people for adulthood. Whilst for some it will be difficult, many parents can help by using public transport with their children as much as possible so that they get used to it as a normal mode of travel. Parents can help by training their children to use public transport independently as they get older. Schools and colleges also help by offering independent travel training to help children and young people achieve independent living outcomes in their Education, Health and Care Plan. Wherever possible, there is an expectation for children and young people to travel to and from school or college independently.

Useful documents, websites and contact numbers:

	Website	Contact or further information
Cycling	www.westsussex.gov.uk/cycling	01243 642105
School Travel Plans	Contact individual schools direct (see pages 19-46 of this booklet)	Contact individual schools direct (see pages 19-46 of this booklet)
School Crossing Patrols	www.westsussex.gov.uk/schooltransport	Contact individual schools direct or School Crossing Patrol Service on 01243 642105
Home to school and college transport policies	www.westsussex.gov.uk/schooltransport	Pages 53-54 of this booklet
Travel planning	www.travelinesoutheast.org.uk www.travelwestsussex.co.uk	0871 200 2233
Bus timetables and fares	www.westsussex.gov.uk	Contact bus operators direct
Rail timetables and fares	www.nationalrail.co.uk	08457 48 49 50
Sussex Student Card and rail discount scheme	www.westsussex.gov.uk/schooltransport	Leaflets also available at schools, colleges and railway stations
Safer Routes to School and Travel Planning	www.westsussex.gov.uk	srts.team@westsussex.gov.uk
Bus Infrastructure improvements	www.westsussex.gov.uk	bus.stops@westsussex.gov.uk

West Sussex Home to School Transport Policy

You will receive help to a community or voluntary controlled school if your child is:

- of statutory school age and is under 8 years old and
- lives two miles or more from their catchment or nearest suitable school

or

- is 8 years or over and
- lives three miles or more from their catchment or nearest suitable school.

Distance is measured by the shortest walking route.

Help will also be given to families on low income if your child is 8 or over and you live two miles or more from the catchment or nearest suitable school. To qualify you must be eligible for free school meals or the family must be receiving Working Tax Credit at the maximum level. In these circumstances, help is given until the end of the school year. A fresh application is required the following year.

Help with transport is not offered to children attending church aided schools unless it is also the nearest school to the home address.

Please note that the school transport policy and school transport arrangements are subject to review from time to time.

To make enquiries regarding eligibility for transport and for full details of the County Council's school transport policy, please contact the Transport Bureau, The Grange, Tower Street, Chichester, West Sussex PO19 1RH (01243)753530.

If you are unhappy with a Transport Decision

If you are not satisfied with a decision about your entitlement to free transport or assistance, you should contact the Transport Bureau to discuss this matter. If you feel there are special circumstances you may appeal to the Director of Education and Skills for the case to be reconsidered. In exceptional circumstances, the case may be referred to an appeal panel of elected members.

In-year applications to join an established year group

An in-year admission is the admission of a pupil to a school which takes place outside of the normal admission round. This includes pupils changing schools, pupils coming from a different country or from other parts of the UK, pupils returning to a school from living elsewhere or those who have not been in school. If a child is coming from abroad to the UK for the first time then the child must be in the country when you apply. However, if the child has previously lived in the UK, **and** you can prove that you are returning to a property which you own or rent in West Sussex, then you can apply in advance of the child arriving in the country. If in doubt please contact the Pupil Admissions Team for advice.

If you are thinking of changing schools because your child is not getting on at their current school then you should always discuss your reasons for the move with the current school. If you remove your child from school and home educate for less than six months your child will be expected to return to their previous school if there is space available. In-year applications will only be considered under the exceptional and compelling criteria at the time of the original application, unless there is an unforeseeable change of circumstance after the application was made.

Details of how to make an in-year application, which form to use and where to send it can be found at www.westsussex.gov.uk/admissions, or you can telephone 03330 142 903 for advice and an application form. Online applications made at a weekend are treated as being received on the next working day. In-year applications for schools outside West Sussex should be made direct to that school or Local Authority.

Where West Sussex County Council processes applications, either as the Admissions Authority for the school or on behalf of the governing body of an own admission authority school, we aim to do so within ten

school days of receipt, although this can be longer at busy times or if required information is delayed or complex. We can only offer a place if there are spaces in that year group and places for established year groups cannot be reserved in advance. You can make an in-year application at any time and places normally have to be taken up within 10 school days. The exception is that in-year applications for September entry (apart from the intake year) can be made from 19 May and will be processed from 1 June. In-year applications for September received on or before 18 May will be returned to the applicant and must be resubmitted on or after 19 May. Where preferences cannot be met parents will be advised of how to go on the waiting list and their right of appeal.

Where West Sussex County Council does not process In Year applications on behalf of the governing body of an own admission authority school, you need to contact the school direct. It should be noted that schools that require completion of a Supplementary Information Form (SIF), for example church voluntary aided schools or academies with a religious character, will also need this for an In Year application.

Special rules apply to in-year applications for the following groups of children:

Service Personnel - West Sussex County Council is committed, in accordance with The Armed Forces Covenant, to ensuring that members of the Armed Forces Community suffer no disadvantage in accessing public services. Members of the armed forces with automatic right of entry to the UK who are able to provide evidence of their relocation may apply for a school place ahead of a move. An application can be made as soon as confirmation of the relocation is available, with no restriction on how far in advance the application can be made. Armed forces applications must be supported by an official letter that declares a relocation date and a Unit postal address or quartering area address and it is this address that will be used when considering the application. There is no guarantee that a place will be available at a preferred school; each application will be considered in line with the school's admissions criteria.

Crown Servants - Crown servants with automatic right of entry to the UK who are able to provide evidence of their relocation may apply for a school place ahead of a move. An application can be made as soon as confirmation of the relocation is available, with no restriction on how far in advance the application can be made. For crown servants a United Kingdom address can only be used if there is evidence of the address the child is returning to. There is no guarantee that a place will be available at a preferred school; each application will be considered in line with the school's admissions criteria.

Vulnerable Children – In accordance with the School Admissions Code, a Fair Access Protocol exists to ensure that un-placed children, especially the most vulnerable, for example children who are homeless or children who are carers, are offered a place at a suitable school as quickly as possible. You will be contacted after you have returned an application form if your application is to be processed under the Fair Access Protocol.

Glossary

Academy

Academies are independently managed schools. They are set up by sponsors from business, faith or voluntary groups in partnership with the Department for Education (DfE) and the Local Authority. Academies are run by their own governing body, which sets the admissions criteria and makes admissions decisions.

Admission Authority

The body that decides which children can attend a school, based on their Admission Policy. For community and voluntary controlled schools this is the Local Authority. For academies, church voluntary aided schools, foundation schools and free schools, it is the Governing Body.

Back-classing

The Department for Education expects pupils to be educated in their correct chronological year group. A back-classing arrangement is when a child who has already been in receipt of education repeats an academic year and is therefore educated outside of their chronological year group. This is an exceptional arrangement and applications must be supported by the current or most recent school.

Catchment School

The school(s) that serve a specific area or address.

Church Voluntary Aided School

Church voluntary aided schools are schools with a religious character which are run by their own Governing Body, which sets the admissions criteria and makes admissions decisions. They are maintained by the Local Authority but the governing body contributes to building and maintenance costs.

Community School

A community school is one which is funded and run by the Local Authority, who set the admissions criteria and makes decisions. The school is maintained by the Local Authority.

Co-ordinated Admissions

During the 'Normal Admissions Round' Local Authorities are required to co-ordinate admissions for all pupils in an area. This means that every parent of a child living in West Sussex who has applied for a school place receives an offer of only one school place.

Delayed entry

Delayed entry is when a **summer born** child starts school having reached statutory school age. They join a year group lower than their chronological year group. See page 13 of this booklet for further information.

Education, Health and Care Plan

Replaces a Statement of Special Educational Needs (see below) from 1 September 2014.

Deferred Entry

Deferred entry is when a pupil starting school for the first time starts school later than the first term of the academic year, often to continue attending nursery. Admission to school will still comply with statutory start dates i.e. the term after the child's fifth birthday, and to the correct year group.

Fair Access Protocol

The Fair Access Protocol is a requirement of the School Admissions Code to ensure that – outside the normal admissions round - unplaced children, especially the most vulnerable, are offered a place at a suitable school as quickly as possible. The operation of the Fair Access Protocol is triggered when a parent of an eligible child has not secured a school place under in-year admission procedures.

Foundation (including trust) School

A school where the Governing Body employs the school's staff and have a responsibility for admission arrangements. The school's land and buildings are owned by the Governing Body or by a charitable foundation or trust.

Free Schools

Free schools are a type of Academy. They are set up by local people/groups. They are funded by the Department for Education (DfE). Free schools are run by their own Governing Body, which sets the admissions criteria and makes admissions decisions.

Independent School

A school that charges fees and controls its own admissions, which are not co-ordinated by the Local Authority. Also known as Private Schools.

In-Year Admissions

In-year admissions are applications made on or after the first day of the school term of the admission year for a place in an established year group.

Local Authority

The council responsible for co-ordinating admissions to schools in the area and for determining admission arrangements and managing admissions to community and voluntary controlled schools. In West Sussex this is West Sussex County Council.

Looked After Children

A child who is registered as being in the care of the Local Authority or being provided with accommodation by the Local Authority (under Section 22 of the Children's Act 1989).

Normal Admissions Round

The period during which parents are invited to express three preferences for a place at any state-funded school, in rank order on the common application form provided. In West Sussex this period runs from when applications open on 2 October 2017 to our processing deadline of 15 February 2018. The deadline for on time parental applications is 15 January 2018. Applications received between 16 January 2018 and 15 February 2018 are out of time applications determined before the National Offer Day. Applications received between 16 February 2018 and 3 September 2018 are late applications outside the normal admissions round.

Number on Roll

This is the total number of children at a school on a specific date.

Oversubscribed

A school is oversubscribed when it has more applications than the number of places available (published admission number).

Preferences

Parents have the right to state which three schools they would like their child to attend. However, there can be no guarantee that a place will be allocated at the preferred schools if they are oversubscribed.

Previously Looked After Children

For school admission purposes a Previously Looked After Child is a child who was a Looked After Child but ceased to be so because they were adopted, or became subject to a Residence Order, Child Arrangements Order or Special Guardianship Order, immediately following having been looked after.

Private Fostering

If you are caring for someone else's child for more than 28 days, you do not have parental responsibility for them and you are not a relative such as a grandparent, brother, sister, uncle or aunt (whether full blood, half blood or by marriage or civil partnership) or step-parent, you may be private fostering. It is a legal requirement that you contact West Sussex County Council on: 01403 229900 or email: MASH@westsussex.gcsx.gov.uk

Published Admission Number (PAN)

This is the number of places available in each year group at a school, based on the actual accommodation at the school.

Sibling

A brother or sister. School admissions policies should define exactly what this means. In community and controlled schools brothers and sisters can be half or step siblings (by marriage or cohabitation) or foster siblings sharing a common address. Cousins are not classed as siblings. Some academies, church voluntary aided schools, free schools and foundation schools may take another approach and you should check the school's information.

Statement of Special Educational Need

A formally recognized assessment of a child's additional needs. (N.B. Replaced by an Education, Health and Care Plan from 1 September 2014.)

Voluntary Controlled School

Voluntary Controlled Schools are religious or 'faith' schools, but are run by the Local Authority, which sets the admissions criteria and makes admissions decisions. They are usually smaller village schools that have CE in their name (also known as a voluntary-controlled school).

USEFUL CONTACT TELEPHONE NUMBERS

Pupil Admissions Team (Northern Area)

County Hall North, Chart Way, Horsham,
RH12 1XH

Telephone: 03330 142 903

Fax: 01403 276460

Email: admissions.north@westsussex.gov.uk

Pupil Admissions Team (Southern Area)

Centenary House, Durrington Lane, Worthing,
BN13 2QB

Telephone: 03330 142 903

Fax: 01903 839214

Email: admissions.south@westsussex.gov.uk

Special Educational Needs Assessment Team:

Telephone numbers:

0330 222 8881: Chichester, Bognor Regis,
Midhurst, Petworth

0330 222 8882: Angmering, Littlehampton,
Steyning, Worthing, Shoreham, Lancing,
Horsham West

0330 222 8883: Crawley, Burgess Hill, Horsham
East, Haywards Heath, Cuckfield, East Grinstead

Pupil Entitlement Team - Investigations:

Telephone: 0330 222 8200 (8.30am to 1.30pm)

Elective Home Education:

Telephone: 0330 222 3300

Private Fostering Team

01403 229900

or email: MASH@westsussex.gcsx.gov.uk

Contact details for Diocesan Education Offices

Church of England Schools

Director, Diocesan Board of Education

Diocese of Chichester

211 New Church Road

Hove, East Sussex BN3 4ED

Telephone: 01273 421021

Catholic Schools

Director of Education

Diocese of Arundel and Brighton

Education Service

4 Southgate Drive

Crawley, West Sussex

RH10 6RD

Telephone: 01293 511130

Neighbouring Authorities

East Sussex County Council

Admissions and Transport Team, County Hall, St
Anne's Crescent, Lewes, East Sussex, BN7 1SG.

Telephone: 0300 330 9472

www.eastsussex.gov.uk

Kent County Council

Admissions and Transport Team, Room 2.24,
Sessions House, County Hall, Maidstone, Kent,
ME14 1XQ.

Telephone: 03000 412121

www.kent.gov.uk/schooladmissions

Surrey County Council

Admissions and Transport Team, Quadrant Court,
35 Guildford Road, Woking, Surrey, GU22 7QQ

Telephone: 0300 200 1004 www.surreycc.gov.uk

Brighton and Hove City Council

School Admissions Team

Brighton and Hove City Council, Hove Town Hall
Norton Road, Hove, BN3 3BQ.

Telephone: 01273 293653

www.brighton-hove.gov.uk

Hampshire County Council

County Admissions Team, Children's Services
Department, The Castle, Winchester, Hampshire,
SO23 8UG.

Telephone: 0300 555 1377 www.hants.gov.uk

Portsmouth City Council

Admissions Service, Portsmouth City Council,
Civic Offices, Guildhall Square,

Portsmouth, PO1 2EA

Telephone: 023 9268 8008

www.portsmouth.gov.uk

West Sussex Admissions North and South areas



Data Protection Act 1998

The information supplied by parents in their application is held on computer and may be checked against other information held by West Sussex County Council and any related agency. Your child's information is covered by the Data Protection Act which gives anyone with parental responsibility the right to apply to access that information, by making written application to The Information Officer, Legal Services Unit, West Sussex County Council, County Hall, Chichester, PO19 1RQ. Please note we may share your information without your consent if there is a legal requirement to do so (or if there is a risk of serious harm or threat to life).

This authority is under a duty to protect the public funds it administers, and to this end may use the information provided in an application for the prevention and detection of fraud. It may also share this information with other bodies responsible for auditing or administering public funds for these purposes. For further information, see www.westsussex.gov.uk/nfi.

This brochure relates to the school year starting September 2018 and is as accurate as possible. However, there may be changes during the year as a result of developments in central or local government policies, or at individual schools. Please check with the Pupil Admissions Team if you are unclear about anything.